



2018 AASHE Conference & Expo
"Global Goals: Rising to the Challenge"
October 2-5, 2018
Pittsburgh, Pennsylvania

Schedule At-A-Glance

TUESDAY, Oct. 2, 2018

Registration	7:30 a.m. - 6:30 p.m.	Concourse A
Student Summit	8:30 a.m. - 4:30 p.m.	Floor 3
(\$) Pre-Conference Workshops	8:30 a.m. - 4:30 p.m.	Floors 3 & 4
Opening Ceremony & Keynote	4:45 p.m. - 6:00 p.m.	Ballroom
Expo Hall Opening Reception	6:00 p.m. - 8:00 p.m.	Expo Hall

WEDNESDAY, Oct. 3, 2018

Registration	7:30 a.m. - 5:00 p.m.	Concourse A
Session A	8:30 a.m. - 9:00 a.m.	Floors 3 & 4
Session B	9:15 a.m. - 10:15 a.m.	Floors 3 & 4
Exhibits Open	10:00 a.m. - 5:00 p.m.	Expo Hall
Coffee/Networking Break	10:15 a.m. - 10:45 a.m.	Expo Hall
Session C	10:45 a.m. - 11:15 a.m.	Floors 3 & 4
Session D	11:30 a.m. - 12:30 p.m.	Floors 3 & 4
Lunch n' Learn with Exhibitors (lunch served 12:30-1:30)	12:30 p.m. - 3:00 p.m.	Expo Hall
Poster Session	2:30 p.m. - 4:30 p.m.	Expo Hall
Networking Meetings	4:45 p.m. - 5:45 p.m.	Floors 3 & 4

THURSDAY, Oct. 4, 2018

Registration	7:30 a.m. - 3:30 p.m.	Concourse A
Session E	8:30 a.m. - 9:00 a.m.	Floors 3 & 4
Session F	9:15 a.m. - 10:15 a.m.	Floors 3 & 4
Exhibits Open	10:00 a.m. - 2:00 p.m.	Expo Hall
Coffee/Networking Break	10:15 a.m. - 10:45 a.m.	Expo Hall
Lunch n' Learn with Exhibitors (lunch served 12:15-1:15)	12:00 p.m. - 2:00 p.m.	Expo Hall
Networking Meetings	12:45 p.m. - 1:45 p.m.	Floors 3 & 4
Session G	2:00 p.m. - 2:30 p.m.	Floors 3 & 4
Session H	2:45 p.m. - 3:45 p.m.	Floors 3 & 4
Closing Ceremony & Keynote	4:00 p.m. - 5:15 p.m.	Ballroom

FRIDAY, Oct. 5, 2018

Registration	7:00 a.m. - 9:00 a.m.	Concourse A
(\$) Post-Conference Workshops	8:30 a.m. - 12:00 p.m.	Floor 3

Events marked with (\$) are not included in the conference registration price and are offered for a separate fee. If you didn't pre-register for a workshop, you can still register on-site anytime up to 30 minutes before the event is scheduled to begin. If space is still available, you can also register for tours on-site but you must do so by 5 p.m. on the day before the tour (e.g., for an event taking place on Friday, you must be registered by 5 p.m. on Thursday).

AASHE 2018 Mobile App

Stay connected with other attendees and access the full conference schedule with the AASHE 2018 Conference mobile app.

This interactive app will allow you to:

- View the complete event schedule and get detailed information about each session and presenter
- Filter sessions depending on your track of interest or session level and create your own schedule
- Access color maps for the Convention Center and Expo Hall which include session room locations and the poster session
- Receive important schedule changes, alerts and obtain the most up-to-date event information.
- Post updates to sessions, keynotes and exhibitor booths.

** Available for iPhone, iPad and Android



To download the app:

Search the App Store or Google Play for “AASHE 2018”

Scan using your device's QR code scanner to access the AASHE 2018 app.

WiFi Details for David L. Lawrence Convention Center:

WiFi Network Name: **AASHE**

WiFi Password: **AASHE2018****

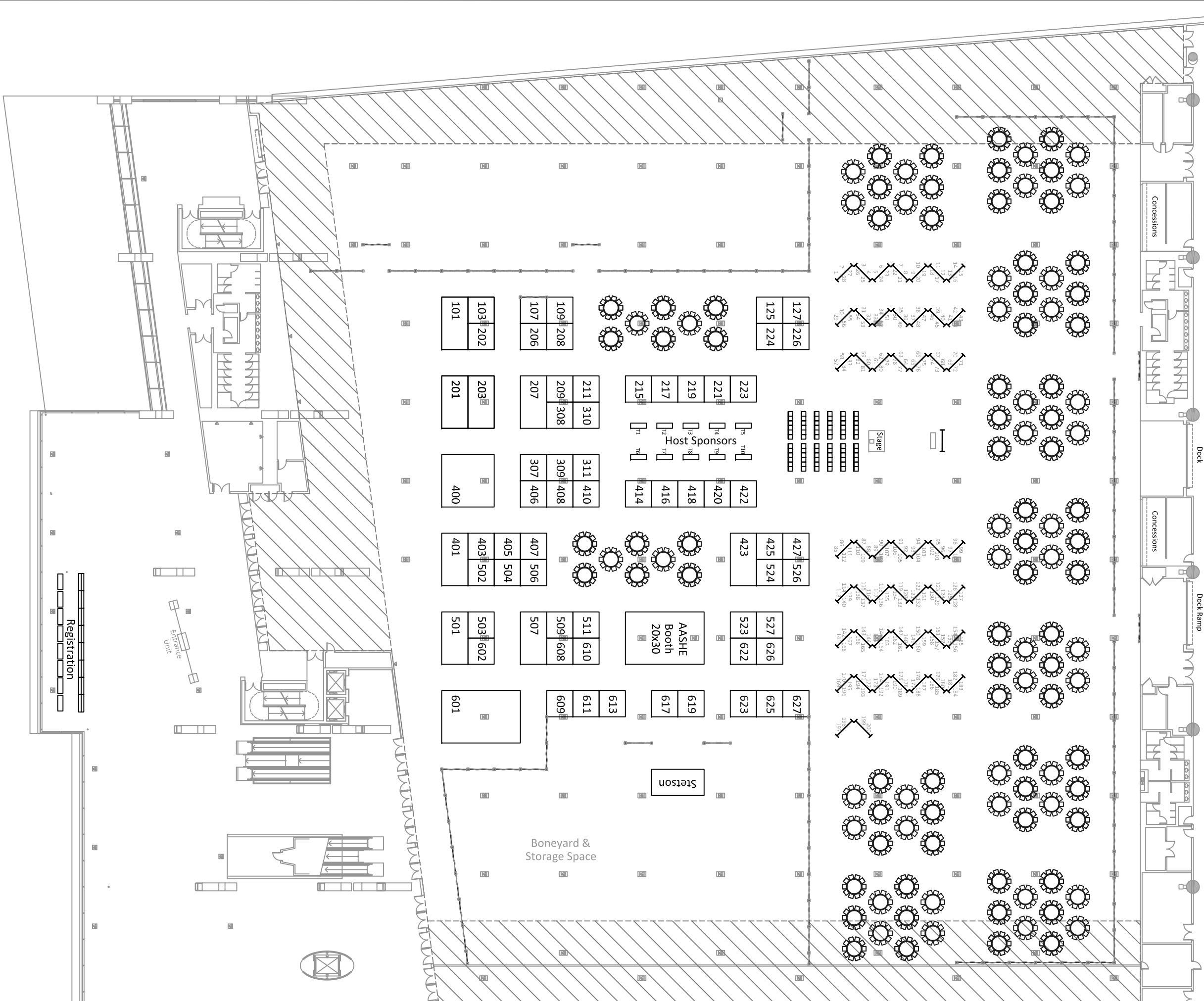
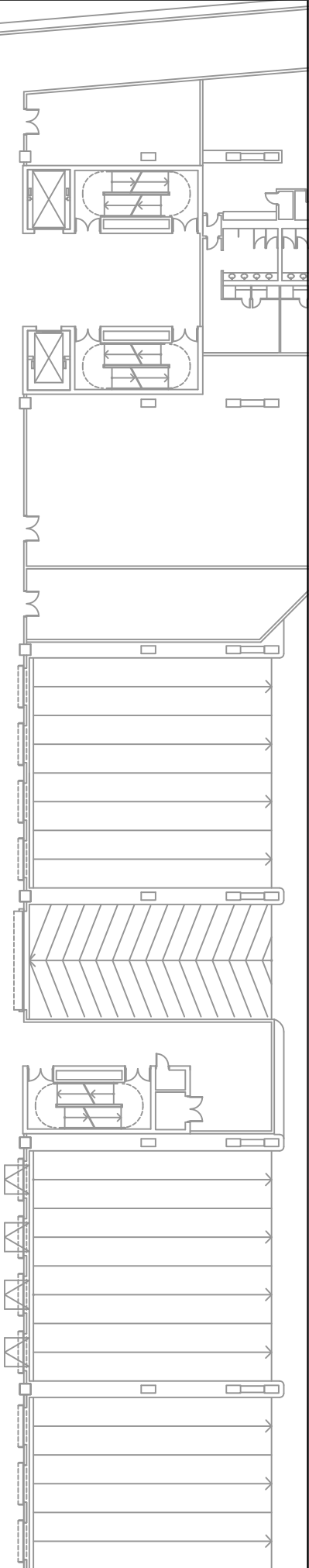

AASHE 2018			
David L Lawrence Convention Center-- Hall A			
pdf, Name: AASHE 2018_9.21.18			
Dwg, Name: AASHE 2018			
Dwg Date: 9.21.2018	By: AH	Rev: 7	FMA: Pending
All Booths are 10' wide unless noted otherwise			
All Aisles are 10' wide unless noted otherwise			
Show Colors:			



STETSON

CONVENTION SERVICES

SUSTAINABLY PRODUCED EXPOSITIONS

2900 Sayton Street, Pittsburgh PA 15212

PH: 412.223.1090 - FX: 412.223.1094

E-MAIL: shawk@stetsonexpo.com

Booths	
Dimensions	Quantity
10x10	58
10x20	8
20x20	1
20x30	2
Totals:	79

Disclaimer
Every effort has been made to ensure the accuracy of all information contained on this floor plan. However no warranties, either expressed or implied are made with respect to this floor plan. If the location of building columns, utilities of other architectural components of the facility is a consideration of construction or usage of an exhibit, it is the sole responsibility of the exhibitor to physically inspect the facility to verify all dimensions and locations.

Start Time	End Time	Event Title	Room	Primary Track	Sess. Level
Monday, 10/1/18					
12:30 p.m.	8:00 p.m.	Maximizing Human and Ecological Health in the Built Environment: Tour, Workshop, and Reception (\$)	off-site		
1:00 p.m.	4:00 p.m.	Carnegie Mellon University's Tepper Quad Facility: A New Vision of Education (\$)	off-site		
Tuesday, 10/2/18					
7:30 a.m.	6:30 p.m.	Registration Open	Concourse A		
Student Summit (8:30 a.m. - 4:30 p.m.)					
8:30 a.m.	9:45 a.m.	Keynote - Garrett Blad	302-305		
9:45 a.m.	10:15 a.m.	Coffee Break - Student Summit & Pre-Conference Workshops Attendees	Regional Gallery		
10:15 a.m.	11:15 a.m.	Local to Global - 5 Strategies for Leaders to Win Change Now and After Graduation	315	Campus Engagement	Intermediate Level
10:15 a.m.	11:15 a.m.	Advocacy for the Global Goals	316	Campus Engagement	Introductory Level
10:15 a.m.	11:15 a.m.	A Zero Waste Campus is Possible	317	Waste	Introductory Level
10:15 a.m.	11:15 a.m.	Secrets to Success for Your Career and Your Campus in Sustainability	318	Wellbeing & Work	Intermediate Level
10:15 a.m.	11:15 a.m.	Shifting to 100% Renewable Campuses and Communities	319	Energy	Introductory Level
10:15 a.m.	11:15 a.m.	Anti-Oppressive Youth Facilitation	320	Diversity & Affordability	Introductory Level
10:15 a.m.	11:15 a.m.	Put Your Fork Where Your Ethics Are: Exploring Food Systems & Leveraging University Purchasing Power	321	Food & Dining	Introductory Level
11:30 a.m.	12:00 p.m.	Award Winner: Community-Driven Reuse Initiatives	318	Campus Engagement	Introductory Level
11:30 a.m.	12:00 p.m.	Creating a Sustainability Director Position for the Student Body Government	315	Campus Engagement	Introductory Level
11:30 a.m.	12:00 p.m.	Student-Developed Energy Management Information System	316	Energy	Introductory Level
11:30 a.m.	12:00 p.m.	Creating a Culture of Sustainability: Implementing Zero Waste in Student Union Buildings	317	Waste	Intermediate Level
11:30 a.m.	12:00 p.m.	Agrioltaic Arrays: Cultivating the Future of Renewable Energy	319	Energy	Introductory Level
11:30 a.m.	12:00 p.m.	Environmental Social Justice's Role in the Sustainable Development Goals	320	Diversity & Affordability	Introductory Level
11:30 a.m.	12:00 p.m.	Student Funded Initiatives & the Intersections of Social Justice & Sustainability	321	Campus Engagement	Introductory Level
12:00 p.m.	1:00 p.m.	Lunch for Student Summit Attendees & Pre-Conference Full Day Workshop Attendees	302-305		
1:00 p.m.	2:00 p.m.	How to Create Sustainable Solutions in Your Community	315	Coordination & Planning	Introductory Level
1:00 p.m.	2:00 p.m.	Moving Toward Climate Justice Through Divestment and Reinvestment	316	Investment & Finance	Introductory Level
1:00 p.m.	2:00 p.m.	Shaping Perceptions: Creative Explorations of Personal & Community Resiliency Through Art & Movement	317	Wellbeing & Work	Introductory Level
1:00 p.m.	2:00 p.m.	Resilience and Renewal - A Retreat Model: Preparing Ourselves for a Lifetime of Global Change	318	Wellbeing & Work	Introductory Level
1:00 p.m.	2:00 p.m.	Putting A Price On Carbon: Fighting for Strong Climate Policy on the Campus, State and Federal Level	319	Air & Climate	Introductory Level
1:00 p.m.	2:00 p.m.	Sustainability, Equity & Inclusivity: Diversifying the Conversation	320	Campus Engagement	Introductory Level
1:00 p.m.	2:00 p.m.	Building and Supporting Social Movements for Institutional Change and Beyond	321	Campus Engagement	Introductory Level
2:15 p.m.	2:45 p.m.	How to Get Reusable Dining Containers on Your Campus!	315	Food & Dining	Intermediate Level
2:15 p.m.	2:45 p.m.	Divestment and Bureaucracy: how to Capitalize on and Celebrate Small Incremental Change	316	Investment & Finance	Intermediate Level
2:15 p.m.	2:45 p.m.	Accessible and Ethical E-Waste: Adaptability in Infrastructure	317	Waste	Introductory Level
2:15 p.m.	2:45 p.m.	Organizational Transitions and Continuity in a University Setting	318	Coordination & Planning	Intermediate Level
2:15 p.m.	2:45 p.m.	From Student Power to Renewable Energy: A New Approach to Investing in Solar	319	Energy	Intermediate Level
2:15 p.m.	2:45 p.m.	Big Food in our Universities: Exploring the Ties Between Institutions and Big Food Corporations	320	Food & Dining	Introductory Level
2:15 p.m.	2:45 p.m.	The Campus Kitchens Project: Connecting the Campus and the Community	321	Campus Engagement	Introductory Level
2:45 p.m.	3:30 p.m.	Networking Break with Student Summit Partners	Regional Gallery		
3:30 p.m.	4:30 p.m.	Four Steps for Leading Impactful Environmental Change On-Campus	316	Campus Engagement	Introductory Level
3:30 p.m.	4:30 p.m.	From 'Fix it Fest' to Fix it First: Nurturing a Campus Culture of Reuse	317	Campus Engagement	Introductory Level
3:30 p.m.	4:30 p.m.	Stay Rad Post Grad: Finding Your Path After College	318	Wellbeing & Work	Introductory Level
3:30 p.m.	4:30 p.m.	Creative Approaches for Engaging People in Climate Action	319	Air & Climate	Intermediate Level
3:30 p.m.	4:30 p.m.	Sustaining our Communities Through Care and Action	320	Wellbeing & Work	Introductory Level
3:30 p.m.	4:30 p.m.	Campus Advocacy for Global Impact: Fair Trade and the United Nations SDGs	321	Food & Dining	Introductory Level

Start Time	End Time	Event Title	Room	Primary Track	Sess. Level
(\$ Pre-Conference Workshops					
8:30 a.m.	4:30 p.m.	Developing and Utilizing a Social Justice Lens in Order to Achieve Global Goals for Sustainability (\$)	408	Diversity & Affordability	Intermediate Level
8:30 a.m.	4:30 p.m.	CURC Campus Recycling Workshop (\$)	409	Waste	Introductory Level
8:30 a.m.	4:30 p.m.	Facilitation for Organizational Change (\$)	411	Campus Engagement	Advanced Level
8:30 a.m.	4:30 p.m.	Advancing Carbon Pricing at Your Institution (\$)	412	Air & Climate	Introductory Level
8:30 a.m.	4:30 p.m.	6th AASHE Workshop on Research for Sustainability: Investigating Sustainable Urban Systems (\$)	413	Research	Intermediate Level
12:00 p.m.	1:00 p.m.	Lunch for Student Summit & Pre-Conference Full Day Workshop Attendees	302-305		
8:30 a.m.	12:00 p.m.	Resilience Bootcamp - Turning Threats into Opportunities (\$)	326	Coordination & Planning	Introductory Level
8:30 a.m.	12:00 p.m.	Applied Learning: Interventions for Sustainability Impacts (\$)	327	Curriculum	Intermediate Level
8:30 a.m.	12:00 p.m.	Creating an Ecologically Restorative, Socially Just, and Culturally Rich Campus (\$)	328	Buildings	Introductory Level
8:30 a.m.	12:00 p.m.	Rising to Meet the Challenge of 100% Renewable Energy (\$)	329	Energy	Advanced Level
8:30 a.m.	12:00 p.m.	Biophilic Design Principles and Green Infrastructure: Forging New Possibilities for Nature, Harmony and Resiliency in Urban Environments (\$)	330	Buildings	Advanced Level
1:00 p.m.	4:30 p.m.	Organizing a Campus-Community Resilience Building Workshop (\$)	326	Coordination & Planning	Introductory Level
1:00 p.m.	4:30 p.m.	Develop Your Toolkit for Sustainability Communications (\$)	327	Campus Engagement	Introductory Level
1:00 p.m.	4:30 p.m.	Catch: A Face-to-Face Simulation Game for Teaching About Sustainability and Resource Management (\$)	328	Curriculum	Intermediate Level
1:00 p.m.	4:30 p.m.	Leverage Your Renewable Energy Impact Through Emerging Avoided Emissions PPA Strategies (\$)	329	Air & Climate	Advanced Level
9:45 a.m.	10:15 a.m.	Coffee Break - Student Summit & Pre-Conference Workshops Attendees	Regional Gallery		
2:45 p.m.	3:30 p.m.	Coffee Break - Student Summit & Post-Conference Workshops Attendees	Regional Gallery		
Tuesday Afternoon and Evening Events					
4:45 p.m.	6:00 p.m.	Opening Program and Keynote - Akpezi Ogbuigwe	Ballroom		
6:00 p.m.	8:00 p.m.	Expo Hall Opening Reception	Expo Hall A		
Wednesday, 10/3/18					
7:30 a.m.	5:00 p.m.	Registration Open	Concourse A		
7:30 a.m.	8:15 a.m.	Gentle Morning Yoga	307	Wellbeing & Work	Introductory Level
Extended Session A (8:30 a.m. - 12:30 p.m.) Pre-Registration closed					
8:30 a.m.	12:30 p.m.	Advancement & Sustainability: Partnering for Fundraising and Alumni Engagement	301	Public Engagement	Advanced Level
Session A (8:30 a.m. - 9:00 a.m.) 30-minute Sessions					
8:30 a.m.	9:00 a.m.	Award Winner: Recapturing the Learning Opportunities of University Sustainability Indicators	316	Campus Engagement	Intermediate Level
8:30 a.m.	9:00 a.m.	Film Festival: Sustainability Perspectives: A Video Showcase	406	Campus Engagement	Introductory Level
8:30 a.m.	9:00 a.m.	Divestment: How Public Universities Can Defund Climate Change	302	Investment & Finance	Intermediate Level
8:30 a.m.	9:00 a.m.	Increasing Diversity in a Sustainability Internship Program	303	Diversity & Affordability	Intermediate Level
8:30 a.m.	9:00 a.m.	Addressing Collegiate Basic Needs Through the Sustainability Lens	304	Diversity & Affordability	Introductory Level
8:30 a.m.	9:00 a.m.	The Power of Process: Thoughtful Engagement for Successful Projects	305	Coordination & Planning	Intermediate Level
8:30 a.m.	9:00 a.m.	Three Zeros Environmental Initiative at UNC Chapel Hill: The Chancellor's Sustainability Charge	315	Coordination & Planning	Advanced Level
8:30 a.m.	9:00 a.m.	A Primer on Living Wage Policies and Just Employment	317	Wellbeing & Work	Introductory Level
8:30 a.m.	9:00 a.m.	Educating, Engaging and Empowering Sustainable Businesses Through a Smart Business Challenge	318	Public Engagement	Introductory Level
8:30 a.m.	9:00 a.m.	EAN Sustainability Index: How to Measure the Sustainability in an University Incubator?	319	Public Engagement	Introductory Level
8:30 a.m.	9:00 a.m.	Activism or Silence as a Sustainability Office?	320	Campus Engagement	Introductory Level
8:30 a.m.	9:00 a.m.	Building a Consistent Sustainability Brand	321	Campus Engagement	Introductory Level
8:30 a.m.	9:00 a.m.	Fast-tracking a Comprehensive Responsible Leadership Initiative Highlighting the UN 2030 SDGs	323	Campus Engagement	Intermediate Level
8:30 a.m.	9:00 a.m.	Undergrads as Consultants: Sharing Strategies and Experiences From a Student Intern Program	324	Campus Engagement	Introductory Level
8:30 a.m.	9:00 a.m.	Placed-based Education in Co-Curricular Programs: Bringing Global Goals to Local Places	325	Campus Engagement	Intermediate Level
8:30 a.m.	9:00 a.m.	Ecological Grief: How Higher Education Responds to Environmental Trauma	326	Research	Introductory Level
8:30 a.m.	9:00 a.m.	Digital Tools to Enhance Integrative Learning and Global Perspectives in Sustainability Studies	327	Curriculum	Introductory Level

Start Time	End Time	Event Title	Room	Primary Track	Sess. Level
8:30 a.m.	9:00 a.m.	Mathematics for Sustainability: A New General Education Course and Textbook	328	Curriculum	Introductory Level
8:30 a.m.	9:00 a.m.	Sustainable Justice in Wisconsin: Strategies for Program Growth in Harsh Climates	329	Curriculum	Introductory Level
8:30 a.m.	9:00 a.m.	Planning and Implementing a University-Wide Curriculum Disruption to Teach About Climate Justice	330	Curriculum	Intermediate Level
8:30 a.m.	9:00 a.m.	GHG Accounting in Higher Education - The Case for Forging Our Own Path	401	Air & Climate	Introductory Level
8:30 a.m.	9:00 a.m.	Dockless Bikeshare Successes: Minimizing Risks Through Proactive Planning and Communication	402	Transportation	Introductory Level
8:30 a.m.	9:00 a.m.	Evolving Pennsylvania State University's Sustainability Policy Within a Regenerative Paradigm	403	Buildings	Intermediate Level
8:30 a.m.	9:00 a.m.	Reduce Peak Demand and Increase Grid Stability With On-Site Energy Storage	404	Energy	Advanced Level
8:30 a.m.	9:00 a.m.	Using Sub-Metering to Prioritize and Measure Energy Management Projects	405	Energy	Introductory Level
8:30 a.m.	9:00 a.m.	Using FEEDS Communication Platform to Share Sustainability News From Dining Services	408	Food & Dining	Intermediate Level
8:30 a.m.	9:00 a.m.	Student Funded Initiatives & the Intersections of Social Justice & Sustainability	409	Food & Dining	Intermediate Level
8:30 a.m.	9:00 a.m.	Resource Management Contracting- How It Can All Go Wrong When You Do Everything Right	410	Waste	Intermediate Level
8:30 a.m.	9:00 a.m.	Do Dorm Move-Out Waste Reduction Programs Really Reduce Carbon Emissions?	411	Waste	Intermediate Level
8:30 a.m.	9:00 a.m.	Great Gardening Goals: Aligning WMU's Gibbs Permaculture Site With the UN's SDGs	412	Grounds	Introductory Level
8:30 a.m.	9:00 a.m.	Environmental Impact and Cost Savings Data for Low Speed Electric Vehicles on College Campuses	413	Transportation	Introductory Level
Session B (9:15 a.m. - 10:15 a.m.): 60-minute Sessions					
9:15 a.m.	10:15 a.m.	Award Winner: Carbon Pricing on Campus: Four Models for Higher Ed Engagement on a Climate Solution	401	Air & Climate	Introductory Level
9:15 a.m.	10:15 a.m.	Award Winner: On-Campus Water Reclamation: A Tale of Two Cities	412	Water	Intermediate Level
9:15 a.m.	10:15 a.m.	Film Festival: Reel Sustainability: Connecting to Audiences Through Video Storytelling	406	Campus Engagement	Introductory Level
9:15 a.m.	10:15 a.m.	Advocating for Sustainability: Effective Communications With Finance	302	Investment & Finance	Intermediate Level
9:15 a.m.	10:15 a.m.	An Introduction to the Role of Race, Class and Gender Issues on Campus Sustainability Work	303	Diversity & Affordability	Introductory Level
9:15 a.m.	10:15 a.m.	Latin Flavor in AASHE: Contributions to Sustainability Offices	304	Coordination & Planning	Intermediate Level
9:15 a.m.	10:15 a.m.	Top Down and Bottom-Up: The Pitt Sustainability Planning Process	305	Coordination & Planning	Intermediate Level
9:15 a.m.	10:15 a.m.	Got Plans? Perspectives on Developing and Implementing Campus Sustainability Plans	315	Coordination & Planning	Intermediate Level
9:15 a.m.	10:15 a.m.	How Do Sustainability and Resilience Work Together in Practice?	316	Coordination & Planning	Advanced Level
9:15 a.m.	10:15 a.m.	Performing at a Higher Level - Healthy Buildings for Your Campus	317	Buildings	Introductory Level
9:15 a.m.	10:15 a.m.	Community Outreach on Steroids: Impacting People in 8 Counties While Recruiting Great Students	318	Public Engagement	Introductory Level
9:15 a.m.	10:15 a.m.	Mapping our Participation in the United Nations Global Compact: Storytelling and Sustainability	319	Public Engagement	Intermediate Level
9:15 a.m.	10:15 a.m.	Academic Libraries Fostering Resilient Communities	320	Campus Engagement	Introductory Level
9:15 a.m.	10:15 a.m.	Break out of a Social Media Slump: How to Create a Strategy, Build Community & Engage Your Audience	321	Campus Engagement	Introductory Level
9:15 a.m.	10:15 a.m.	Beyond the Ball: Sustainability Success in Nontraditional Athletics	323	Campus Engagement	Introductory Level
9:15 a.m.	10:15 a.m.	Sustainability in American Topics: US History, Conservation, and Sustainable Development Goals	324	Curriculum	Advanced Level
9:15 a.m.	10:15 a.m.	Introducing the Campus Community to the UN Sustainable Development Goals	325	Campus Engagement	Introductory Level
9:15 a.m.	10:15 a.m.	Pursuing the SDGs in Education Abroad: Tools, Techniques, and Assessment Strategies	326	Curriculum	Intermediate Level
9:15 a.m.	10:15 a.m.	From the 3Es to the SDGs: Updating Sustainability Frameworks Used as Educational Tools	327	Curriculum	Intermediate Level
9:15 a.m.	10:15 a.m.	Key Competencies in Sustainability: Overview and Next Steps	328	Curriculum	Introductory Level
9:15 a.m.	10:15 a.m.	University Workshops Cultivating a Culture of Sustainability on Campus and Beyond	329	Curriculum	Introductory Level
9:15 a.m.	10:15 a.m.	Design Thinking and Sustainability	330	Curriculum	Introductory Level
9:15 a.m.	10:15 a.m.	From Cars to Bikes - A Campus Transformation	402	Transportation	Advanced Level
9:15 a.m.	10:15 a.m.	Nailing Net Zero, From Design to Certification	403	Buildings	Advanced Level
9:15 a.m.	10:15 a.m.	Transforming Our Tomorrow—A New Clean Energy Vision	404	Energy	Advanced Level
9:15 a.m.	10:15 a.m.	Transitioning a 100-year Legacy of Campus Steam to 21st Century Geothermal	405	Energy	Intermediate Level
9:15 a.m.	10:15 a.m.	Food Service Contracts and RFPs as Vehicle for Sourcing More Sustainable Food	408	Food & Dining	Introductory Level
9:15 a.m.	10:15 a.m.	Lessons from Year 1 of Turning the Page on Campus Paper Use	409	Purchasing	Introductory Level
9:15 a.m.	10:15 a.m.	Implementing an Effective Campus Recycling & Waste Bin Infrastructure	410	Waste	Intermediate Level
9:15 a.m.	10:15 a.m.	Move Out Solutions With William & Mary's DormMania and the Post-Landfill Action Network	411	Waste	Introductory Level
9:15 a.m.	10:15 a.m.	Changing Plates: How Aramark Partnered With HSUS to Lead Sustainable Change Through Food	413	Food & Dining	Introductory Level
10:15 a.m.	10:45 a.m.	Coffee / Networking Break	Expo Hall A		

Start Time	End Time	Event Title	Room	Primary Track	Sess. Level
Session C (10:45 a.m. - 11:15 a.m.): 30-minute Sessions					
10:45 a.m.	11:15 a.m.	Award Winner: Infusing Sustainability in Higher Education in Ireland - The Green Curriculum Model (GCM)	326	Curriculum	Advanced Level
10:45 a.m.	11:15 a.m.	Film Festival: Food Conscious Campus: Urban Innovations Towards Zero Hunger	406	Public Engagement	Intermediate Level
10:45 a.m.	11:15 a.m.	Environmental Justice Grant Funding: Piloting Equity Efforts in Campus Green Funds	302	Campus Engagement	Intermediate Level
10:45 a.m.	11:15 a.m.	Building Relationships Between Sustainability Offices and Diversity Offices	303	Diversity & Affordability	Introductory Level
10:45 a.m.	11:15 a.m.	Food and Housing Security Among NC State Students	304	Diversity & Affordability	Intermediate Level
10:45 a.m.	11:15 a.m.	Global Priorities, Educated Solutions: the Role of Academia in Advancing the SDGs	305	Coordination & Planning	Intermediate Level
10:45 a.m.	11:15 a.m.	Preaching Beyond the Choir: How to Institutionalize Sustainability Into Organization-Wide Culture	315	Coordination & Planning	Advanced Level
10:45 a.m.	11:15 a.m.	Shooting for the STARS - How your Campus can use STARS to Measure Progress Toward the SDGs	316	Coordination & Planning	Introductory Level
10:45 a.m.	11:15 a.m.	Well-Being for All, Sustainably at Dawson College	317	Wellbeing & Work	Intermediate Level
10:45 a.m.	11:15 a.m.	Measuring Student Attitudes Towards Sustainable Development With a One-Semester Sustainovation	318	Public Engagement	Introductory Level
10:45 a.m.	11:15 a.m.	Urban Forestry and Community Engagement - the Chemis-tree of Successful Partnerships	319	Public Engagement	Intermediate Level
10:45 a.m.	11:15 a.m.	CU Boulder Tests Behavior-Tracking Platform's Effect on Student Engagement in Sustainability	320	Campus Engagement	Intermediate Level
10:45 a.m.	11:15 a.m.	How to Podcast Your Way to a More Environmentally Sustainable and Socially Just Future	321	Campus Engagement	Introductory Level
10:45 a.m.	11:15 a.m.	Partnering Student Green Advisors With Staff Advocates: Swarthmore's Innovative Eco-Reps Model	323	Campus Engagement	Intermediate Level
10:45 a.m.	11:15 a.m.	Changemaker Maps: A Roadmap to Transform Your Backyard and Your World	324	Campus Engagement	Introductory Level
10:45 a.m.	11:15 a.m.	Advancing Organizational Change for Sustainable Development Goals Through Neuropsychology	325	Campus Engagement	Advanced Level
10:45 a.m.	11:15 a.m.	Linking Teaching Practices to Students' Pro-Sustainability Behaviors	327	Curriculum	Intermediate Level
10:45 a.m.	11:15 a.m.	STARS Reporting as an Undergraduate Educational Opportunity	328	Curriculum	Intermediate Level
10:45 a.m.	11:15 a.m.	AIM2Flourish: Transforming Management Education Through Positive Business Innovation Stories	329	Curriculum	Introductory Level
10:45 a.m.	11:15 a.m.	How to Create an Innovative and Interdisciplinary Sustainability Major	330	Curriculum	Intermediate Level
10:45 a.m.	11:15 a.m.	Climate Resiliency Planning: What We're Learning	401	Air & Climate	Intermediate Level
10:45 a.m.	11:15 a.m.	A Sustainable Parking Framework and Strategies to Encourage More Sustainable Transportation	402	Transportation	Intermediate Level
10:45 a.m.	11:15 a.m.	The Trials and Tribulations of Building a Living-Learning Sustainable Campus	403	Buildings	Intermediate Level
10:45 a.m.	11:15 a.m.	Getting to 100% Renewable Electricity	404	Energy	Advanced Level
10:45 a.m.	11:15 a.m.	The Present & Future of the Open Energy Dashboard	405	Energy	Intermediate Level
10:45 a.m.	11:15 a.m.	Driving Food Reconnection at Arizona State University through Collaboration between USP and Aramark	408	Food & Dining	Introductory Level
10:45 a.m.	11:15 a.m.	Sustainable Procurement: Strengthening the Voice of Sustainability When Partnering With Procurement	409	Purchasing	Intermediate Level
10:45 a.m.	11:15 a.m.	Bin There, Done That: Mapping CSUN's Outdoor Waste Infrastructure	410	Waste	Introductory Level
10:45 a.m.	11:15 a.m.	Engaging Housekeeping Staff for Zero Waste Success	411	Waste	Intermediate Level
10:45 a.m.	11:15 a.m.	Rising to the Global Biodiversity Challenge: A New Model at the University of British Columbia	412	Grounds	Intermediate Level
10:45 a.m.	11:15 a.m.	How a College Student Turned His Campus Sustainability Program Into a Fortune 500 Company	413	Wellbeing & Work	Introductory Level
Session D (11:30 a.m. - 12:30 p.m.): 60-minute Sessions					
11:30 a.m.	12:30 p.m.	Film Festival: Urban Living Lab Video Short	406	Research	Intermediate Level
11:30 a.m.	12:30 p.m.	Solutions for Evaluating Projects: Quadruple Bottom Line & Financial Models for Climate Neutrality	302	Investment & Finance	Intermediate Level
11:30 a.m.	12:30 p.m.	Moving Past Tokenization: Integrating Social Equity Internally and Programmatically	303	Diversity & Affordability	Intermediate Level
11:30 a.m.	12:30 p.m.	Decolonizing a College's Farm-to-Table Dinner	304	Diversity & Affordability	Intermediate Level
11:30 a.m.	12:30 p.m.	Imposters, Insiders, and Collaborators: Bringing Outside Expertise to the World of Sustainability	305	Coordination & Planning	Intermediate Level
11:30 a.m.	12:30 p.m.	Leveraging the SDG's to Build a System-Wide Higher Education Sustainability Strategy	315	Coordination & Planning	Intermediate Level
11:30 a.m.	12:30 p.m.	Is STARS Pre-Submission Review Required Now?	316	Coordination & Planning	Intermediate Level
11:30 a.m.	12:30 p.m.	This Justice In: Updated Results From the Living Wage Policy Study	317	Wellbeing & Work	Intermediate Level
11:30 a.m.	12:30 p.m.	Universities as Catalysts for Transformative Sustainable Change	318	Public Engagement	Intermediate Level
11:30 a.m.	12:30 p.m.	Localizing UN Sustainable Development Goals in Hawaii: The Community as our Living Laboratory	319	Public Engagement	Introductory Level
11:30 a.m.	12:30 p.m.	Peer-to-Peer Educator Programs: Examining Four Common Styles	320	Campus Engagement	Intermediate Level
11:30 a.m.	12:30 p.m.	Students, Sustainability, and Social Media: Tools for Content and Collaboration	321	Campus Engagement	Intermediate Level
11:30 a.m.	12:30 p.m.	Becoming a Social Organism: Action Research Turns Environmental Research Into a Sustainable Act	323	Research	Intermediate Level

Start Time	End Time	Event Title	Room	Primary Track	Sess. Level
11:30 a.m.	12:30 p.m.	Campus Controversies: How Should Sustainability Offices Respond?	324	Campus Engagement	Introductory Level
11:30 a.m.	12:30 p.m.	Involving the Greek Community in Sustainability	325	Campus Engagement	Introductory Level
11:30 a.m.	12:30 p.m.	Greening the Chemistry Research and Teaching Labs: Resources to Increase Safety and Reduce Waste	326	Curriculum	Introductory Level
11:30 a.m.	12:30 p.m.	Pulling the Paradox of the SDGs down to Uneven Ground: A Transdisciplinary Learning Journey	327	Curriculum	Advanced Level
11:30 a.m.	12:30 p.m.	Study Abroad Partnerships in China	328	Curriculum	Introductory Level
11:30 a.m.	12:30 p.m.	Enhancing Student Learning and Promoting Sustainability Through Experiential Learning	329	Curriculum	Introductory Level
11:30 a.m.	12:30 p.m.	Creating Learning, Teaching, and Operational Partnerships Through Campus as a Living Labs	330	Curriculum	Intermediate Level
11:30 a.m.	12:30 p.m.	Understanding the Entire Campus Carbon Footprint: How and Why to do Comprehensive Scope 3 Reporting	401	Air & Climate	Intermediate Level
11:30 a.m.	12:30 p.m.	How University Transportation Practitioners are Transforming USGBC's Global Transportation Emphasis	402	Transportation	Intermediate Level
11:30 a.m.	12:30 p.m.	Making Positive Impacts With Zero Energy Buildings	403	Buildings	Introductory Level
11:30 a.m.	12:30 p.m.	Getting to a Green Light: How to Build Organizational Buy-In for Large-Scale Renewable Energy	404	Energy	Intermediate Level
11:30 a.m.	12:30 p.m.	So You've Got Energy Meters - Now what? Dealing With the Other Challenges to Getting Energy Data	405	Energy	Introductory Level
11:30 a.m.	12:30 p.m.	Lettuce Talk: Students and Dining Staff Collaborating on Plant-Based Dining	408	Food & Dining	Introductory Level
11:30 a.m.	12:30 p.m.	Raising the Bar Across North America: Tracking Sustainable Food Purchasing in Higher Education	409	Food & Dining	Introductory Level
11:30 a.m.	12:30 p.m.	Thinking Outside of the Trash: Waste Policy Implementation and Education at Emory University	410	Waste	Advanced Level
11:30 a.m.	12:30 p.m.	Identifying Holistic Metrics to Redefine Zero Waste	411	Waste	Advanced Level
11:30 a.m.	12:30 p.m.	Pollinator Friendly Campuses: Strategies to Help You Get Your Buzz on!	412	Grounds	Introductory Level
11:30 a.m.	12:30 p.m.	Crowdcoaching: A Workshop About Workshops	413	Curriculum	Intermediate Level
10:00 a.m.	5:00 p.m.	Meet AASHE Exhibitors!	Expo Hall A		
12:30 p.m.	3:00 p.m.	Lunch n' Learn With Exhibitors (Lunch Served 12:30-1:30)	Expo Hall A		
12:30 p.m.	2:30 p.m.	Expo Hall Tours - Advance Sign Up Required at Registration Desk or AASHE Booth - Space Is Limited	AASHE Booth		
12:45 p.m.	1:15 p.m.	Oregon Presents "Electrify Groundskeeping and Eliminate Noise Nuisance for a More Sustainable Campus"	Exhibitor Showcase		
1:30 p.m.	2:30 p.m.	Rheaply Presents "Circular Design Showcase"	Exhibitor Showcase		
1:30 p.m.	2:30 p.m.	STARS Clinic	AASHE Booth	STARS	Introductory Level
2:30 p.m.	4:30 p.m.	Poster Session With Refreshments	Expo Hall A		
Networking Meetings (4:45 p.m. - 5:45 p.m.)					
4:45 p.m.	5:45 p.m.	Integrating Diversity, Equity & Inclusion Into Higher Ed Sustainability Work	303	Diversity & Affordability	Intermediate Level
4:45 p.m.	5:45 p.m.	International Networking Meeting	304	Coordination & Planning	Intermediate Level
4:45 p.m.	5:45 p.m.	New York Coalition for Sustainability in Higher Education (NYCSHE) Meet-Up	305	Coordination & Planning	Introductory Level
4:45 p.m.	5:45 p.m.	Help! I Don't Know What I'm Doing: Campus Sustainability Officers Support Group	315	Coordination & Planning	Intermediate Level
4:45 p.m.	5:45 p.m.	Texas Regional Alliance for Campus Sustainability (TRACS) Networking Session	316	Campus Engagement	Introductory Level
4:45 p.m.	5:45 p.m.	Ivy+ Sustainability Meeting	317	Coordination & Planning	Advanced Level
4:45 p.m.	5:45 p.m.	Service and Community Engaged Learning for Social and Environmental Justice	318	Curriculum	Intermediate Level
4:45 p.m.	5:45 p.m.	Colorado Colleges and Universities Sustainability Group	319	Campus Engagement	Introductory Level
4:45 p.m.	5:45 p.m.	Arizona Colleges and Universities Networking	320	Campus Engagement	
4:45 p.m.	5:45 p.m.	Sustainability Communicators Networking Meeting	321	Campus Engagement	Introductory Level
4:45 p.m.	5:45 p.m.	Co-Curricular Learning and Sustainable Development Competencies: Towards Research Collaboration	324	Campus Engagement	Intermediate Level
4:45 p.m.	5:45 p.m.	Green Gurus Unite! Discussing the Promise and Perils of Becoming Your School's Moral Compass	325	Campus Engagement	Introductory Level
4:45 p.m.	5:45 p.m.	Centers for Sustainability Across the Curriculum Gathering - By invitation only	327	Curriculum	Introductory Level
4:45 p.m.	5:45 p.m.	Upper Midwest Association for Campus Sustainability (UMACS) Networking Session	328	Campus Engagement	Introductory Level
4:45 p.m.	5:45 p.m.	How Do We Meaningfully Integrate Sustainability Into Global Studies Curricula?	330	Curriculum	Introductory Level
4:45 p.m.	5:45 p.m.	Carbon Pricing on Campus: Networking Session for Institutions Advancing Carbon Pricing Solutions	401	Air & Climate	Introductory Level
4:45 p.m.	5:45 p.m.	Transportation Networking Meeting	402	Transportation	Introductory Level
4:45 p.m.	5:45 p.m.	Researching and Purchasing Real Food on Campus	408	Food & Dining	Introductory Level
4:45 p.m.	5:45 p.m.	College & University Recycling Coalition (CURC) Membership Meeting	410	Waste	Intermediate Level
4:45 p.m.	5:45 p.m.	Lessons From the Compost Pile: a Facilitated Conversation About Campus Compost Initiatives	411	Waste	Intermediate Level

Start Time	End Time	Event Title	Room	Primary Track	Sess. Level
4:45 p.m.	5:45 p.m.	University Zero Waste Research Center Networking Session	412	Waste	Intermediate Level
Thursday, 10/4/18					
7:30 a.m.	3:30 p.m.	Registration Open	Concourse A		
7:30 a.m.	8:15 a.m.	Gentle Morning Yoga	307	Wellbeing & Work	Introductory Level
7:30 a.m.	8:15 a.m.	State of the Association Address: AASHE Member Meeting	305		
Session E (8:30 a.m. - 9:00 a.m.): 30-minute Sessions					
8:30 a.m.	9:00 a.m.	Film Festival: Climate Lab: Taking the Gloom out of the Doom	406	Public Engagement	Intermediate Level
8:30 a.m.	9:00 a.m.	Paying for Sustainability: Creating a Relationship With Institutional Advancement	301	Campus Engagement	Introductory Level
8:30 a.m.	9:00 a.m.	The Fossil Fuel Divestment Movement and Student Activism at Syracuse University and SUNY-ESF	302	Campus Engagement	Introductory Level
8:30 a.m.	9:00 a.m.	What About Accessibility? The Intersection of Sustainability and Accessibility on College Campuses	303	Diversity & Affordability	Introductory Level
8:30 a.m.	9:00 a.m.	Achieving SDG Targets: The European Approach: Compliance - The Case of Energy & Irish Universities	304	Coordination & Planning	Intermediate Level
8:30 a.m.	9:00 a.m.	How a Team of Student Ambassadors Can Amplify and Accelerate Wins for a Small Sustainability Staff	305	Coordination & Planning	Introductory Level
8:30 a.m.	9:00 a.m.	Integrating Social Equity: Texas A&M's 2018 Sustainability Master Plan	315	Coordination & Planning	Intermediate Level
8:30 a.m.	9:00 a.m.	Mapping the Pathway to STARS Platinum	316	Coordination & Planning	Intermediate Level
8:30 a.m.	9:00 a.m.	Benefits of Incorporating Well-Being and Diversity Into Sustainability Master Planning	317	Wellbeing & Work	Introductory Level
8:30 a.m.	9:00 a.m.	Climate Memes: Undergraduates Making Climate Data Go Viral	318	Public Engagement	Introductory Level
8:30 a.m.	9:00 a.m.	How Higher Ed Helps Enact Tomorrow's Climate Change Legislation, Today!	319	Public Engagement	Intermediate Level
8:30 a.m.	9:00 a.m.	Fostering Sustainability Culture on an Irish Campus, Lessons Learned from UCC's Green Campus Journey	320	Campus Engagement	Intermediate Level
8:30 a.m.	9:00 a.m.	Graphic Design Strategies for Sustainability	321	Campus Engagement	Introductory Level
8:30 a.m.	9:00 a.m.	How Knowledge Can Create a Culture of Sustainability	323	Campus Engagement	Introductory Level
8:30 a.m.	9:00 a.m.	Intersections: Integrating the UN SDGs to On-Campus Living Environments	324	Campus Engagement	Intermediate Level
8:30 a.m.	9:00 a.m.	An Environmental Sustainability Badge Program Using Co-Curricular and Community Service Learning	325	Campus Engagement	Intermediate Level
8:30 a.m.	9:00 a.m.	Internal Carbon Tax: Methods and Results from the First Rigorous Willingness-to-Pay Study	326	Research	Advanced Level
8:30 a.m.	9:00 a.m.	Sustainability Competencies, SDGs & Metacognition: Implementation and Assessment	327	Curriculum	Introductory Level
8:30 a.m.	9:00 a.m.	Current Issues in Online Sustainability Education	328	Curriculum	Intermediate Level
8:30 a.m.	9:00 a.m.	Why Calculate When I Can Google? Quantitative Tools for Assessing the SDGs	329	Curriculum	Intermediate Level
8:30 a.m.	9:00 a.m.	What if They're Right: Teaching and Responding to Climate Change in the Classroom	330	Curriculum	Introductory Level
8:30 a.m.	9:00 a.m.	Profitable Carbon Capture Technology for Campus Power Plants	401	Air & Climate	Intermediate Level
8:30 a.m.	9:00 a.m.	NE Drawdown: A Multi-College Effort to Adapt & Implement Impactful Regional Climate Change Solutions	402	Air & Climate	Intermediate Level
8:30 a.m.	9:00 a.m.	Becoming BREEAM: How UC Davis Achieved the First Institutional BREEAM In-Use Certification in the US	403	Buildings	Introductory Level
8:30 a.m.	9:00 a.m.	Hitting Bumps in the Road to Renewables	404	Energy	Intermediate Level
8:30 a.m.	9:00 a.m.	The Impact of Real-time Visual Feedback on Electric Consumption at Middlebury College	405	Energy	Introductory Level
8:30 a.m.	9:00 a.m.	BYO[Solutions]: Reuse Programs in Campus Dining	408	Food & Dining	Introductory Level
8:30 a.m.	9:00 a.m.	Fair Trade and the United Nations Sustainable Development Goals	409	Food & Dining	Introductory Level
8:30 a.m.	9:00 a.m.	Rebel Rot: An Engineering Capstone Project to Convert a Dumpster into an In-Vessel Composter	410	Waste	Introductory Level
8:30 a.m.	9:00 a.m.	Zero-Waste Initiative: Composting at Events	411	Waste	Introductory Level
8:30 a.m.	9:00 a.m.	Harvesting Hope for the Future Through Green Infrastructure	412	Water	Introductory Level
8:30 a.m.	9:00 a.m.	Addressing the Global Water Crisis: One Toilet at a Time	413	Water	Introductory Level
Session F (9:15 a.m. - 10:15 a.m.): 60-minute Sessions					
9:15 a.m.	10:15 a.m.	Film Festival: Countdown to Nowruz 2018	406	Campus Engagement	Introductory Level
9:15 a.m.	10:15 a.m.	Transformative Change, the SDGs, and the Future of Sustainability in Higher Education	301	Campus Engagement	Intermediate Level
9:15 a.m.	10:15 a.m.	Student Green Funds: Lessons Learned	302	Investment & Finance	Intermediate Level
9:15 a.m.	10:15 a.m.	Sustainability Best Practices to Contain the Uncontainable: Lessons Learned From UVA & August 11/12	303	Diversity & Affordability	Intermediate Level
9:15 a.m.	10:15 a.m.	Resiliency in the Face of Global Change: Developing a Sustainability Program That Thrives	304	Coordination & Planning	Intermediate Level
9:15 a.m.	10:15 a.m.	Sustainability in the C-Suite: Preliminary Study Results	305	Coordination & Planning	Advanced Level

Start Time	End Time	Event Title	Room	Primary Track	Sess. Level
9:15 a.m.	10:15 a.m.	Projection and Scenario Analysis for Climate and Nitrogen Action Planning	315	Coordination & Planning	Introductory Level
9:15 a.m.	10:15 a.m.	STARS Town Hall	316	STARS	Introductory Level
9:15 a.m.	10:15 a.m.	Adaptation and Resilience in Sustaining Ourselves - A Micro-Retreat	317	Wellbeing & Work	Intermediate Level
9:15 a.m.	10:15 a.m.	UC3: The Research University's Role in Place-Based, Cross-Sector Climate Action	318	Public Engagement	Advanced Level
9:15 a.m.	10:15 a.m.	Blending Sustainability & Community Engagement in STEM: Models from 4 Diverse Universities	319	Public Engagement	Introductory Level
9:15 a.m.	10:15 a.m.	Partnering With Purpose: Curating Sustainability Leadership With Staff, Students, and Faculty	320	Campus Engagement	Intermediate Level
9:15 a.m.	10:15 a.m.	Visual Storytelling for Sustainability: Raising Your Game in Photo and Video	321	Campus Engagement	Introductory Level
9:15 a.m.	10:15 a.m.	Sustainability Surveys for Program Enhancement	323	Campus Engagement	Intermediate Level
9:15 a.m.	10:15 a.m.	Green Office Programs and Certifications	324	Campus Engagement	Intermediate Level
9:15 a.m.	10:15 a.m.	Sustainability-Themed Living and Learning Communities	325	Campus Engagement	Introductory Level
9:15 a.m.	10:15 a.m.	Campus Action Research Advances Sustainable Development Goals	326	Research	Intermediate Level
9:15 a.m.	10:15 a.m.	Student Voices as the Key to Sustainability Assessment	327	Curriculum	Introductory Level
9:15 a.m.	10:15 a.m.	Scenario Planning and Applied Learning in Sustainability Practica	328	Curriculum	Intermediate Level
9:15 a.m.	10:15 a.m.	Achieving SDGs and Engaging Higher Education Using EPA Tools	329	Curriculum	Introductory Level
9:15 a.m.	10:15 a.m.	Using the U.N. SDGs to Foster Systems Thinking in Incoming First-Year Students	330	Curriculum	Introductory Level
9:15 a.m.	10:15 a.m.	Campus & Community Resilience: Experiences from Community College & University Partnerships	401	Air & Climate	Introductory Level
9:15 a.m.	10:15 a.m.	Approaches to Carbon Offset Procurement	402	Air & Climate	Introductory Level
9:15 a.m.	10:15 a.m.	US Department of Energy Funding to Simplify Sustainable Campus Design	403	Buildings	Intermediate Level
9:15 a.m.	10:15 a.m.	Scaling UP Renewable Energy Beyond Campus	404	Air & Climate	Advanced Level
9:15 a.m.	10:15 a.m.	Step Changes in Climate Action: Data-Driven Plans to Decarbonize Campus Energy Systems	405	Energy	Introductory Level
9:15 a.m.	10:15 a.m.	Food Recovery and Partnership Models	408	Food & Dining	Introductory Level
9:15 a.m.	10:15 a.m.	Data-Driven Planning for Campus Materials Management - From Inputs Through Outputs	409	Food & Dining	Introductory Level
9:15 a.m.	10:15 a.m.	Using Waste Audit Data to Drive Waste Reduction, Diversion, and Engagement	410	Waste	Intermediate Level
9:15 a.m.	10:15 a.m.	The Evolution of Campus Composting Programs	411	Waste	Introductory Level
9:15 a.m.	10:15 a.m.	Leadership in Sustainable Grounds Management: The Audubon International Experience	412	Grounds	Intermediate Level
9:15 a.m.	10:15 a.m.	Creating Positive Impact and Achieving Sustainability Goals through Custom Carbon Reduction Projects	413	Air & Climate	Introductory Level
10:00 a.m.	2:00 p.m.	Meet AASHE Exhibitors!	Expo Hall A		
10:15 a.m.	10:45 a.m.	BRE Presents "Advancing Campus Sustainability: Existing Buildings and BREEAM"	Exhibitor Showcase		
10:30 a.m.	11:30 a.m.	STARS Clinic	AASHE Booth	STARS	Introductory Level
10:30 a.m.	1:00 p.m.	Expo Hall Tours - Advance Sign Up Required at Registration Desk or AASHE Booth - Space Is Limited	AASHE Booth		
11:30 a.m.	2:00 p.m.	Lunch n' Learn With Exhibitors (Lunch Served 12:15-1:15)	Expo Hall A		
10:55 a.m.	11:25 a.m.	AGreenOzzi Presents "Learn How to Integrate Reusable Sustainability with Operational Intelligence"	Exhibitor Showcase		
11:35 a.m.	12:05 p.m.	Lime Presents "Scooters, Schools, and Sustainability"	Exhibitor Showcase		
12:15 p.m.	12:45 p.m.	Interface Presents "Creating a Climate Fit for Life"	Exhibitor Showcase		
Networking Meetings (12:45 p.m. - 1:45 p.m.)					
12:45 p.m.	1:45 p.m.	Leading and Integrating Sustainability 2.0: A Discussion About Deep Organizational Change	301	Campus Engagement	Introductory Level
12:45 p.m.	1:45 p.m.	You Ask, We Answer: An Informal Conversation About How AASHE Membership Can Support Your Institution	302	Campus Engagement	Introductory Level
12:45 p.m.	1:45 p.m.	Women Empowerment - Sustainable Development Goal 5	303	Wellbeing & Work	Introductory Level
12:45 p.m.	1:45 p.m.	Canadian Networking Session	305	Campus Engagement	Introductory Level
12:45 p.m.	1:45 p.m.	AASHE Advisory Council Annual Meeting	316	Coordination & Planning	Advanced Level
12:45 p.m.	1:45 p.m.	ISSP Networking Session: Do You Have All It Takes to Be an Effective Sustainability Professional?	317	Coordination & Planning	Introductory Level
12:45 p.m.	1:45 p.m.	How to Overcome Challenges at Large, Urban Campuses	318	Coordination & Planning	Intermediate Level
12:45 p.m.	1:45 p.m.	United Nations Association Campus Network	319	Campus Engagement	Introductory Level
12:45 p.m.	1:45 p.m.	NASPA Sustainability in Student Life Roundtable	320	Campus Engagement	Introductory Level
12:45 p.m.	1:45 p.m.	Social Marketing/Behavior Change Practitioner Meetup	321	Public Engagement	Intermediate Level
12:45 p.m.	1:45 p.m.	Sustainability in the Visual Arts, Design and Creative Fields	323	Curriculum	Introductory Level
12:45 p.m.	1:45 p.m.	Green in a Red State: Working Towards Sustainable Development Goals in a Conservative Environment	324	Campus Engagement	Intermediate Level

Start Time	End Time	Event Title	Room	Primary Track	Sess. Level
12:45 p.m.	1:45 p.m.	Sports & Sustainability: A lunch dialogue	325	Public Engagement	Intermediate Level
12:45 p.m.	1:45 p.m.	Northeast Campus Sustainability Consortium (NECSC) Meeting	326	Public Engagement	Introductory Level
12:45 p.m.	1:45 p.m.	Energize Colleges Networking Meeting	329	Coordination & Planning	Introductory Level
12:45 p.m.	1:45 p.m.	Community College Networking Session	330	Coordination & Planning	Introductory Level
12:45 p.m.	1:45 p.m.	Climate Leadership Commitment Signatory Networking Session	401	Air & Climate	Advanced Level
12:45 p.m.	1:45 p.m.	Fighting Food Waste on College Campuses	408	Waste	Introductory Level
12:45 p.m.	1:45 p.m.	Zero Waste Campus Planning	410	Waste	Intermediate Level
12:45 p.m.	1:45 p.m.	Composting and Organics Collection: Is it Happening On Your Campus?	411	Waste	Introductory Level
Session G (2:00 p.m. - 2:30 p.m.): 30-minute Sessions					
2:00 p.m.	2:30 p.m.	Award Winner: Hampshire College's R.W. Kern Center- A Living & Learning Building	301	Buildings	Introductory Level
2:00 p.m.	2:30 p.m.	Award Winner: From Diversion to Prevention: Re-imagining Waste	413	Waste	Introductory Level
2:00 p.m.	2:30 p.m.	Film Festival: Everett Community College Sustainability Volunteer Program Gets People Working	406	Wellbeing & Work	Intermediate Level
2:00 p.m.	2:30 p.m.	Raising the Bar - Updated Environmental & Social Criteria for EPEAT-Registered Computers/Displays	302	Purchasing	Intermediate Level
2:00 p.m.	2:30 p.m.	Think Outside: Educating about Conservation and Race in the Great Outdoors	303	Diversity & Affordability	Intermediate Level
2:00 p.m.	2:30 p.m.	The Role of Private Sector Partnership in Sustainable Higher Education Operations & Education	304	Coordination & Planning	Introductory Level
2:00 p.m.	2:30 p.m.	Notre Dame's Success in Developing a Sustainability Strategy Aligned to SDGs and Its Mission	305	Coordination & Planning	Introductory Level
2:00 p.m.	2:30 p.m.	Designing a Realistic, Challenging, and Effective Climate Action Plan: Options and Best Practices	315	Coordination & Planning	Introductory Level
2:00 p.m.	2:30 p.m.	Extending Sustainability Practices to Tenant Spaces: Green Leasing at Portland State University	316	Coordination & Planning	Introductory Level
2:00 p.m.	2:30 p.m.	Innovation: Creating a new Minor in Somatic Sustainability at Appalachian State University	317	Wellbeing & Work	Introductory Level
2:00 p.m.	2:30 p.m.	SDG2: Global Challenge, Local Solutions Powered by Penn State University Food Security Initiatives	318	Public Engagement	Introductory Level
2:00 p.m.	2:30 p.m.	Intersections of Food Waste, Hunger, and Spectrums of Homelessness, Abuse, and Addiction	319	Public Engagement	Introductory Level
2:00 p.m.	2:30 p.m.	Incorporating Environmental Justice Into Peer Mentor Programs	320	Campus Engagement	Introductory Level
2:00 p.m.	2:30 p.m.	Bees as a Bridge From Local Experiential Learning to Collaborative Global Education	321	Campus Engagement	Introductory Level
2:00 p.m.	2:30 p.m.	Breaking Down 'Drawdown' - Explaining Global Sustainability Solutions at the Community Level	323	Campus Engagement	Intermediate Level
2:00 p.m.	2:30 p.m.	A New Hope: Training Social Sustainabilistas	324	Campus Engagement	Intermediate Level
2:00 p.m.	2:30 p.m.	Campus Sustainability: A Motivational Analysis for Change	325	Campus Engagement	Intermediate Level
2:00 p.m.	2:30 p.m.	Achieving Intertwined Sustainable Development Goals Through Coastal Resilience Research	326	Research	Intermediate Level
2:00 p.m.	2:30 p.m.	Teaching Sustainability and Environmental Stewardship Through Contemporary Art	327	Curriculum	Introductory Level
2:00 p.m.	2:30 p.m.	Demonstrating Impact Through SDG Cases - Creating Common Language and Shared Purpose Across Campus	328	Curriculum	Intermediate Level
2:00 p.m.	2:30 p.m.	Campus Sustainability 101 - A New Course for First Year Students	329	Curriculum	Intermediate Level
2:00 p.m.	2:30 p.m.	Worry & Hope: Results from a Focus Group Study on Students and Sustainability Curriculum	330	Curriculum	Intermediate Level
2:00 p.m.	2:30 p.m.	From Incremental to Transformative Climate Action: Lessons Learned From Addressing Barriers	401	Air & Climate	Advanced Level
2:00 p.m.	2:30 p.m.	OffsetNetwork.org: Higher Ed's Hub for Self-Generated Offset Projects and Peer Verification	402	Air & Climate	Intermediate Level
2:00 p.m.	2:30 p.m.	Transforming Existing, Iconic, Landmark Buildings Into Modern, High-Performance Buildings	403	Buildings	Advanced Level
2:00 p.m.	2:30 p.m.	Off Site Solar - A Group Effort	404	Energy	Intermediate Level
2:00 p.m.	2:30 p.m.	A Billion Dollar Deal: Public-Private Energy Partnership Advances Campus Effort Beyond Efficiency	405	Energy	Introductory Level
2:00 p.m.	2:30 p.m.	Using Catering to Create a Virtuous Cycle of Sustainability in Your Community	408	Food & Dining	Introductory Level
2:00 p.m.	2:30 p.m.	Encouraging Sustainable Food Purchasing Through Student Programs	409	Food & Dining	Introductory Level
2:00 p.m.	2:30 p.m.	Building an Open Source Food Recovery Website: Pairing University Dining Halls With Shelters	410	Waste	Introductory Level
2:00 p.m.	2:30 p.m.	Break Free From Plastic on Your Campus	411	Waste	Intermediate Level
2:00 p.m.	2:30 p.m.	Urban, Rural, and On-Campus Solutions (UROC): Living Campus Accelerator Toolkit	412	Water	Introductory Level
Session H (2:45 p.m. - 3:45 p.m.) 60-minute Sessions					
2:45 p.m.	3:45 p.m.	Film Festival: Fats, Oils and Grease - 'Don't Flush It'	406	Waste	Introductory Level
2:45 p.m.	3:45 p.m.	Aligning Endowment Investments With the Sustainable Development Goals	302	Investment & Finance	Introductory Level
2:45 p.m.	3:45 p.m.	Turbulent Winds: Addressing 'Climate' at the Intersections of Diversity and Sustainability	303	Diversity & Affordability	Intermediate Level
2:45 p.m.	3:45 p.m.	Engaging Students and Low-Income Community Members: Successes in Conservation and Social Equity	304	Diversity & Affordability	Intermediate Level

Start Time	End Time	Event Title	Room	Primary Track	Sess. Level
2:45 p.m.	3:45 p.m.	Leveraging the Campus Sustainability Committee: Zombie Committees vs Robust Change Agents	305	Coordination & Planning	Intermediate Level
2:45 p.m.	3:45 p.m.	Strategies for an Actionable Sustainability Plan: Tools and Lessons Learned From the Field	315	Coordination & Planning	Intermediate Level
2:45 p.m.	3:45 p.m.	How to Design an Annual Report People Actually Read	316	Coordination & Planning	Introductory Level
2:45 p.m.	3:45 p.m.	Stretching Your Sustainability Leadership Career: Future Business/Facilities Officer	317	Wellbeing & Work	Advanced Level
2:45 p.m.	3:45 p.m.	All We Need is Political Will: Empowering Students on Civic Engagement on Climate Change	318	Public Engagement	Intermediate Level
2:45 p.m.	3:45 p.m.	Taking It to the Next Level: Campus-Community Partnerships	319	Public Engagement	Intermediate Level
2:45 p.m.	3:45 p.m.	Selling Sustainability: 5 Principles of Persuasion	320	Campus Engagement	Introductory Level
2:45 p.m.	3:45 p.m.	Communication Strategies to Reach Beyond the Choir	321	Campus Engagement	Intermediate Level
2:45 p.m.	3:45 p.m.	Student Research as a Gateway to Long-Term Sustainability Projects	323	Campus Engagement	Introductory Level
2:45 p.m.	3:45 p.m.	Wrestling With the Invisibility Cloak: Catalyzing Student Action and Creating Office Recognition	324	Campus Engagement	Introductory Level
2:45 p.m.	3:45 p.m.	Instilling Professional Development Into Eco-Reps Programs	325	Campus Engagement	Intermediate Level
2:45 p.m.	3:45 p.m.	Education as the Engine for the Global Goals	326	Curriculum	Introductory Level
2:45 p.m.	3:45 p.m.	The Sustainability Exchange at Washington University - Interdisciplinary Focus on Real World Issues	327	Curriculum	Intermediate Level
2:45 p.m.	3:45 p.m.	Integration of the SDG's as a Targeted Educational Alternative...A Story of Successful Collaboration	328	Curriculum	Intermediate Level
2:45 p.m.	3:45 p.m.	Uniting Human Rights and Sustainability Across the University	329	Curriculum	Intermediate Level
2:45 p.m.	3:45 p.m.	Green Chemistry: Meeting the Challenge of Equity and Environmental Justice for a Sustainable Future	330	Curriculum	Introductory Level
2:45 p.m.	3:15 p.m.	The Role of Campuses in Driving Climate Resilience Planning	401	Air & Climate	Introductory Level
2:45 p.m.	3:45 p.m.	Mitigating Air Travel Emissions: Measuring, Pricing and Collaboration	402	Transportation	Intermediate Level
2:45 p.m.	3:45 p.m.	New Best Practices for Resilient Design: From Theory to Application	403	Buildings	Intermediate Level
2:45 p.m.	3:45 p.m.	Contracting for Renewable Energy Procurement: Financing and Legal Strategies and Considerations	404	Energy	Intermediate Level
2:45 p.m.	3:45 p.m.	Creating Campus Revenue Streams to Support Sustainability Initiatives	405	Energy	Intermediate Level
2:45 p.m.	3:45 p.m.	Campus Grown: Connecting Sustainability, Local Food Systems, and Experiential Student Learning	408	Food & Dining	Introductory Level
2:45 p.m.	3:45 p.m.	The Dirt on Real/Good Food	409	Food & Dining	Intermediate Level
2:45 p.m.	3:45 p.m.	Successes in Assessing and Reducing Food Waste Through Behavior Change	410	Waste	Introductory Level
2:45 p.m.	3:45 p.m.	Gameday Waste Minimization	411	Waste	Introductory Level
2:45 p.m.	3:45 p.m.	Overcoming Obstacles When Establishing Intentional, Productive Urban Campus Green Spaces: Natural and Man-made Challenges	412	Grounds	Introductory Level
3:30 p.m.	4:00 p.m.	Afternoon Refreshment Break	Ballroom Foyer		
Thursday Afternoon Events					
4:00 p.m.	5:15 p.m.	Closing Program and Keynote - Dr. Paul Shrivastava	Ballroom		
5:30 p.m.	9:00 p.m.	Eden Hall Campus: A Showcase for Sustainable Solutions - (\$)	East Lobby		
Friday, 10/5/18					
(\$) Post-Conference Workshops and Tours					
7:00 a.m.	9:00 a.m.	Registration Open	Concourse A		
8:30 a.m.	12:00 p.m.	To Rise, We Need Critical Conversations About 'Unsustainable' Race, Class & Gender Privilege (\$)	315	Diversity & Affordability	Advanced Level
8:30 a.m.	12:00 p.m.	Key Competencies in Sustainability: Curriculum and Program Development (\$)	316	Curriculum	Intermediate Level
8:30 a.m.	12:00 p.m.	Best Practices in Integrating Sustainability and Business Education (\$)	317	Curriculum	Introductory Level
8:30 a.m.	12:00 p.m.	From Awareness to Action: Behavior Design for Campus Sustainability (\$)	318	Campus Engagement	Introductory Level
10:00 a.m.	10:30 a.m.	Coffee / Networking Break	Gallery		
8:30 a.m.	12:00 p.m.	Sustainability Tour of Pitt's Urban Campus (\$)	East Lobby		

CULTURAL DISTRICT
GARRISON STREET

ALLEGHENY RIVER

RIVERFRONT PLAZA

REGISTRATION
Concourse A

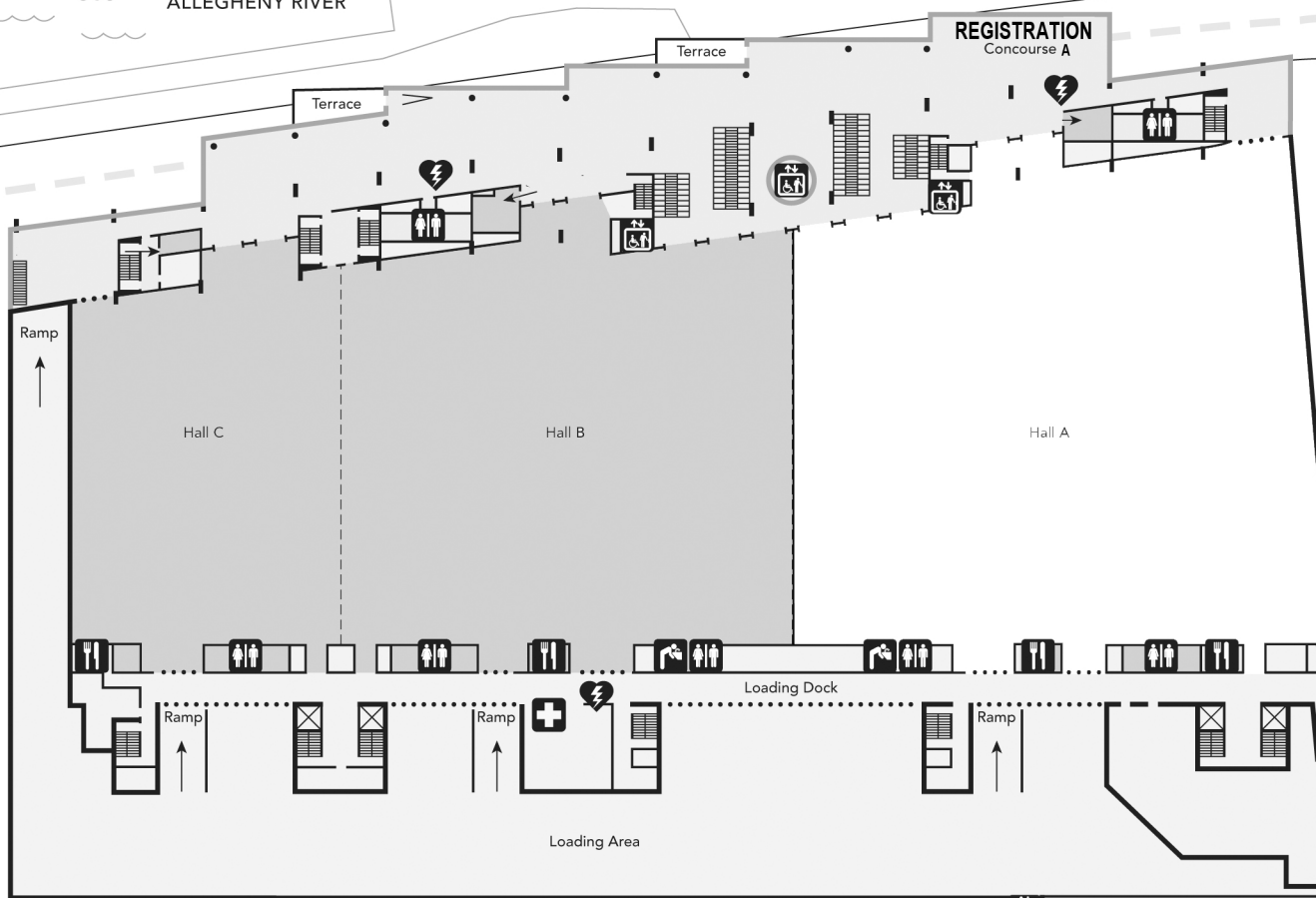

STRIP DISTRICT

SMALLMAN

ELEVENTH STREET

FRENCH STREET

TENTH STREET

Skywalk from the Westin Hotel

SEA Offices

Courtyard by
Marriott

Future Hotel Space

Future Hotel Space

DOWNTOWN PITTSBURGH
PENN AVENUE

BIKE LANE

BIKE LANE

Westin Hotel

- Entrance
- Escalator
- Stairs
- Emergency Exit
- Service Elevator
- Roll Doors
- Glass Doors
- Permanent Art
- Complimentary Wheel Chairs
- Accessible Parking
- Electric Vehicle Charging Station
- Elevators
- Restrooms
- Concessions
- Automated Teller
- Water Fountain
- First Aid
- AED
- Taxi
- Accessible Door Entry

ALLEGHENY RIVER

RIVERFRONT PLAZA

Noresco Riverside Terrace

Noresco Riverside Terrace

Service Corridor

Service Corridor

LEGEND

- Planning & Administration (302-317)
- Campus Engagement & Culture (318-325)
- Academics (326-33)
- Speaker Ready Room (313, 322)
- Nursing Mothers Room (322)
- Yoga Room (307)
- Special Programs (301)
- Ballroom (Opening&Closing Ceremonies)

[Hall C Below]

[Hall B Below]

[Hall A Below]

Service Corridor

Service Corridor

South Terrace

Green Roof

West Atrium

East Atrium

Gallery

Green Room

FRENCH STREET

TENTH STREET

ELEVENTH STREET

SMALLMAN

STRIP DISTRICT

- Entrance
- Escalator
- Stairs
- Emergency Exit
- Service Elevator
- Roll Doors
- Glass Doors
- Permanent Art
- Complimentary Wheel Chairs
- Accessible Parking

- Electric Vehicle Charging Station
- Elevators
- Restrooms
- Concessions
- Automated Teller
- Water Fountain
- First Aid
- AED
- Taxi
- Accessible Door Entry

Courtyard by Marriott

Future Hotel Space

Future Hotel Space

Spirit of Pittsburgh Ballroom

Kitchen Area

Service Corridor

DOWNTOWN PITTSBURGH
PENN AVENUE

BIKE LANE

BIKE LANE

Westin Hotel

ALLEGHENY RIVER

RIVERFRONT PLAZA

North Terrace

Native Plant Boxes

Levy Garden Boxes

LEGEND

Operations (401-412)

Featured Sessions (413)

Film Festival (406)

Roof

Roof

Visitor Corridor

Service Corridor

Service Corridor

Garrison
Overlook

415

414

413

412

411

410

409

408

407

406

405

404

403

402

401

Terrace

Green
Roof
(3rd Floor)

Atrium
Below

Atrium
Below

Terrace

Roof

Service Corridor

FRENCH STREET

TENTH STREET

ELEVENTH STREET

SMALLMAN

STRIP DISTRICT

Courtyard by
Marriott

Future Hotel Space

Future Hotel Space

DOWNTOWN PITTSBURGH
PENN AVENUE

BIKE LANE

BIKE LANE

Westin Hotel

- Entrance
- Escalator
- Stairs
- Emergency Exit
- Service Elevator
- Roll Doors
- Glass Doors
- Permanent Art
- Complimentary Wheel Chairs
- Accessible Parking
- Electric Vehicle Charging Station
- Elevators
- Restrooms
- Concessions
- Automated Teller
- Water Fountain
- First Aid
- AED
- Taxi
- Accessible Door Entry

CULTURAL DISTRICT
GARRISON STREET

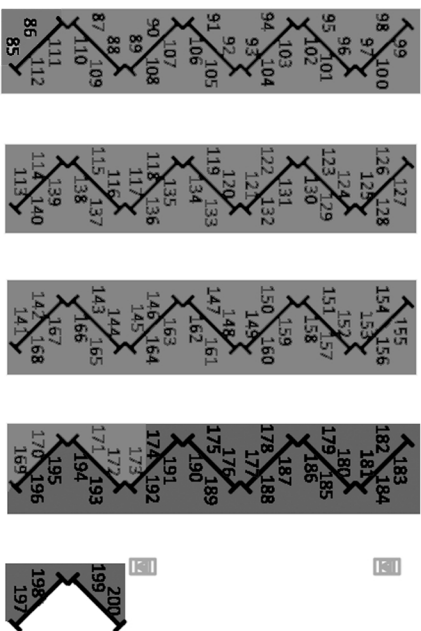
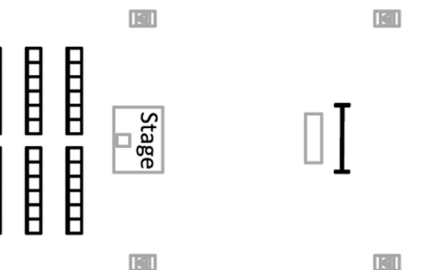
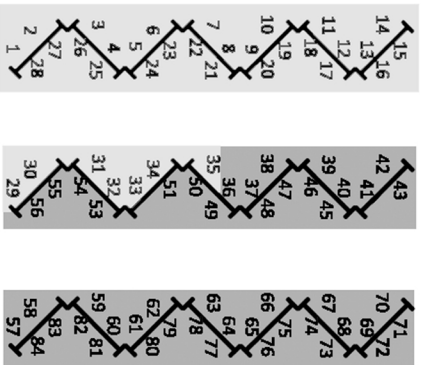

127 226

427 526

627

- Academics Posters 1-35
- Engagement Posters 36-84
- Operations Posters 85-175
- Planning & Administration Posters 176-end

