



2017 AASHE Conference & Expo
"Stronger in Solidarity"
October 15-18, 2017
San Antonio, Texas

Program Overview and Session Schedule

SUNDAY, Oct. 15, 2017

Registration	7:30 a.m. - 6:30 p.m.	Main Lobby
Student Summit	8:30 a.m. - 4:30 p.m.	HGCC
(\$ Pre-Conference Workshops	8:30 a.m. - 4:30 p.m.	HGCC, RC, offsite
Opening Ceremony & Keynote	4:45 p.m. - 6:00 p.m.	Stars Ballroom
Expo Hall Opening Reception	6:00 p.m. - 8:00 p.m.	Exhibit Hall

MONDAY, Oct. 16, 2017

Registration	7:30 a.m. - 5:00 p.m.	Main Lobby
Session A	8:30 a.m. - 9:00 a.m.	HGCC, RC, RW
Session B	9:15 a.m. - 10:15 a.m.	HGCC, RC, RW
Exhibits Open	10:00 a.m. - 4:30 p.m.	Exhibit Hall
Coffee/Networking Break	10:15 a.m. - 10:45 a.m.	HGCC, RC, RW
Session C	10:45 a.m. - 11:15 a.m.	HGCC, RC, RW
Session D	11:30 a.m. - 12:30 p.m.	HGCC, RC, RW
Lunch n' Learn with Exhibitors (lunch served 12:30-2:00)	12:30 p.m. - 3:00 p.m.	Exhibit Hall
Poster Session	3:00 p.m. - 4:30 p.m.	Exhibit Hall
Networking Meetings	4:45 p.m. - 5:45 p.m.	HGCC, RC, RW
Evening Events	6:30 p.m. - 10:00 p.m.	offsite
Special Movie Screening	7:30 p.m. - 10:00 p.m.	Stars Ballroom

TUESDAY, Oct. 17, 2017

Registration	7:30 a.m. - 3:30 p.m.	Main Lobby
Session E	8:30 a.m. - 9:00 a.m.	HGCC, RC, RW
Session F	9:15 a.m. - 10:15 a.m.	HGCC, RC, RW
Exhibits Open	10:00 a.m. - 2:00 p.m.	Exhibit Hall
Coffee/Networking Break	10:30 a.m. - 11:00 a.m.	Exhibit Hall
Lunch n' Learn with Exhibitors	12:00 p.m. - 2:00 p.m.	Exhibit Hall
Networking Meetings	12:45 p.m. - 1:45 p.m.	HGCC, RC, RW
Session G	2:00 p.m. - 2:30 p.m.	HGCC, RC, RW
Session H	2:45 p.m. - 3:45 p.m.	HGCC, RC, RW
Closing Ceremony & Keynote	4:00 p.m. - 5:15 p.m.	Stars Ballroom

WEDNESDAY, Oct. 18, 2017

Registration	7:00 a.m. - 9:00 a.m.	Main Lobby
(\$ Post-Conference Workshops & Tours	8:30 a.m. - 4:00 p.m.	HGCC, offsite

Events marked with (\$) are not included in the conference registration price and are offered for a separate fee. If you didn't pre-register for a workshop, you can still register on-site anytime up to 30 minutes before the event is scheduled to begin. If space is still available, you can also register for tours and evening events on-site but you must do so by 5 p.m. on the day before the tour or evening event (e.g., for an event beginning on Monday evening, you must be registered by 5 p.m. on Sunday).

Legend: HGCC: Henry B. Gonzalez Convention Center; RC: San Antonio Marriott Rivercenter; RW: San Antonio Marriott Riverwalk

This year's conference will take place in three different locations. We strongly encourage you to familiarize yourself with the program overview and layout of the conference in order to make the best use of your time! Consider downloading the mobile app today.

- Henry B. Gonzalez Convention Center (HGCC) - 900 E Market St, San Antonio, TX 78205
Registration, Exhibit Hall, Sunday's Student Summit, some Pre-Conference Workshops, Sunday's Opening Ceremony, Keynote and Reception, Tuesday's Closing Ceremony and Keynote, Breaks and Lunches on Monday and Tuesday; Sessions focused on Coordination & Planning and Campus Engagement on Monday and Tuesday, all Post-Conference Workshops, Tours' meeting point
- San Antonio Marriott Riverwalk (RW) - 889 E Market St, San Antonio, TX 78205
Sessions focused on Operations
- San Antonio Marriott Rivercenter (RC) - 101 Bowie St, San Antonio, TX 78205
Yoga, Sessions focused on Academics, Campus Engagement and Public Engagement

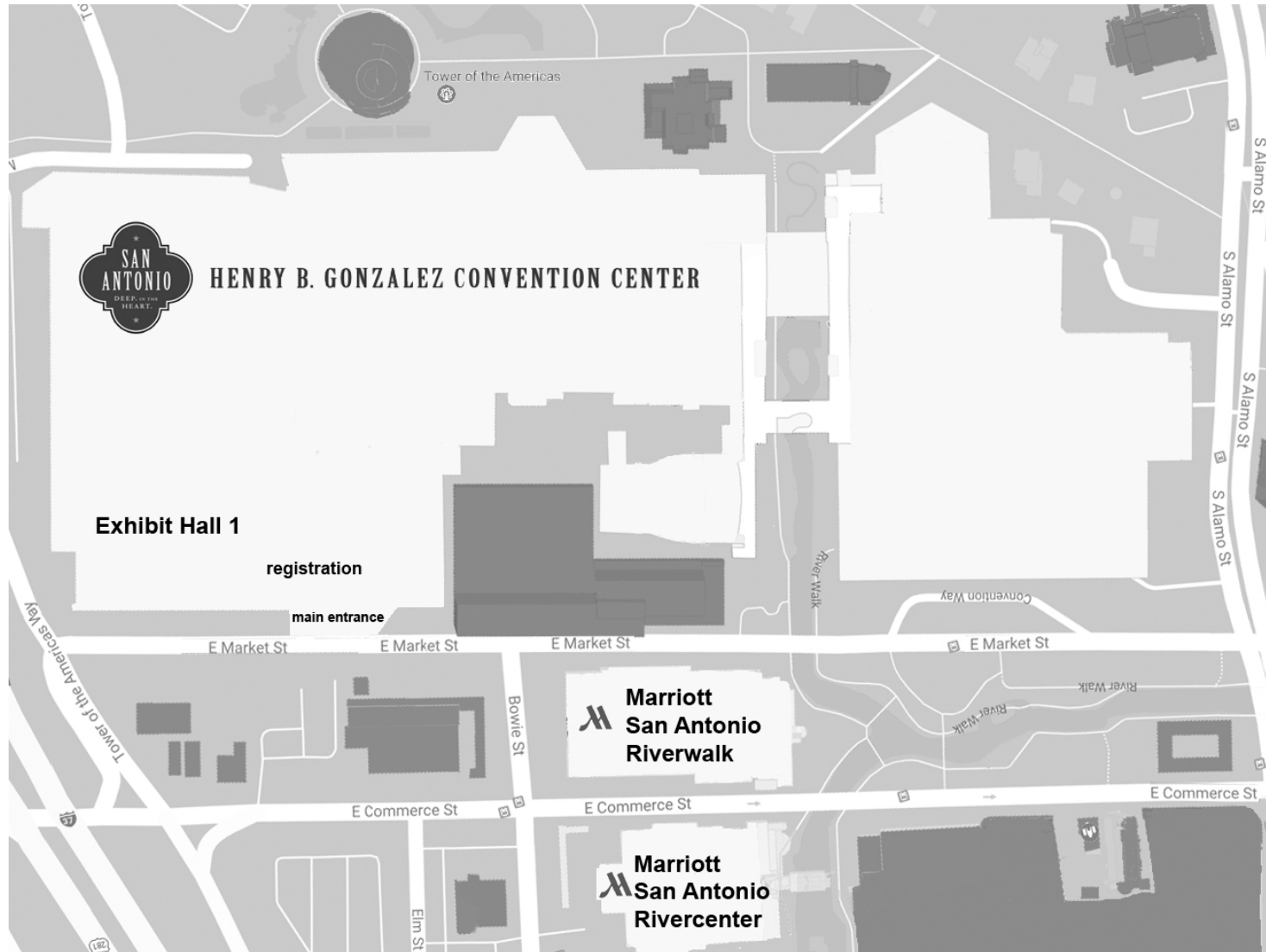

AASHE 2017 Mobile App

Stay connected with other attendees and access the full conference schedule with the AASHE 2017 Conference mobile app.

This interactive app will allow you to:

- View the complete event schedule and get detailed information about each session and presenter
- Filter sessions depending on your track of interest or session level and create your own schedule
- Access color maps for all three locations which include session room locations and the poster session
- Receive important schedule changes, alerts and obtain the most up-to-date event information.
- Post updates to sessions, keynotes and exhibitor booths.

** Available for iPhone, iPad and Android

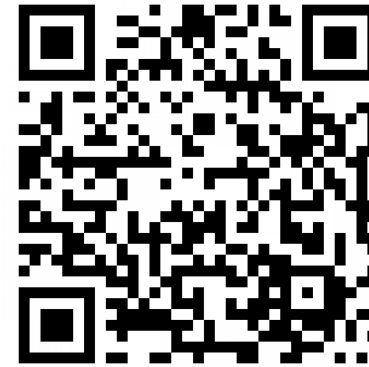

To download the app:

Search the App Store or Google Play for “AASHE 2017”

Scan using your device's QR code scanner to access the AASHE 2017 app.

WiFi Details for Henry B. Gonzalez Convention Center:

WiFi Network Name: **AASHE**

WiFi Password: **AASHE2017**

Start Time	End Time	Event Title	Location	Room	Primary Track	Sess. Level
Saturday, 10/14/17						
1:00 p.m.	9:00 p.m.	Discover UT Austin Through Green Campus Tours	off-site	off-site		
Sunday, 10/15/17						
7:30 a.m.	6:30 p.m.	Registration Open	HGCC	Main Lobby		
12:00 p.m.	1:00 p.m.	Lunch for Student Summit Attendees & Pre-Conference Full Day Workshop Attendees	HGCC	Stars Ballroom 1		
Student Summit (8:30 a.m. - 4:30 p.m.)						
8:30 a.m.	9:45 a.m.	Keynote - Lydia Avila	HGCC	221		
10:00 a.m.	11:15 a.m.	Featured Session: Johnson County Community College Student Sustainability Committee	HGCC	221B	Campus Engagement	Introductory
10:00 a.m.	11:15 a.m.	Building Solidarity through Fair Trade	HGCC	221A	Food & Dining	Introductory
10:00 a.m.	11:15 a.m.	A Zero Waste Campus is Possible	HGCC	221C	Waste	Introductory
10:00 a.m.	11:15 a.m.	Climate Communications: Strategies to Build Political Will	HGCC	225A	Public Engagement	Intermediate
10:00 a.m.	11:15 a.m.	New game, new rules: Organising for Sustainability post-Trump and Brexit	HGCC	225B	Campus Engagement	Intermediate
10:00 a.m.	11:15 a.m.	Social Justice Through a Sustainability Lens	HGCC	225C	Campus Engagement	Introductory
10:00 a.m.	11:15 a.m.	Bee Campus USA: Making the World Safer for Pollinators, One Campus at a Time	HGCC	225D	Grounds	Intermediate
11:30 a.m.	12:00 p.m.	Intercultural Understanding, Garden Benefits, and Sustainability Discourse at the Shawneetown Community Garden	HGCC	221A	Food & Dining	Introductory
11:30 a.m.	12:00 p.m.	Welcome to College! Focusing on Identity + Justice + Sustainability in a First-Year Orientation Program	HGCC	221B	Diversity & Affordability	Introductory
11:30 a.m.	12:00 p.m.	Jumping Through Hoops for Zero-Waste	HGCC	221C	Waste	Introductory
11:30 a.m.	12:00 p.m.	GreenTopics: How we Tackled Reaching Environmental Skeptics	HGCC	225A	Campus Engagement	Introductory
11:30 a.m.	12:00 p.m.	The Campus Climate is Heating up!: A Case Study of Student Activism at a Liberal Arts University	HGCC	225B	Campus Engagement	Introductory
11:30 a.m.	12:00 p.m.	Towards Inclusive Sustainability: Fostering Solidarity in Environmental Work On and Off Campus	HGCC	225C	Diversity & Affordability	Introductory
11:30 a.m.	12:00 p.m.	How Learning Interdependently in Outdoor Settings can Induce a Paradigm Shift & Foster a Yearn to Protect the Natural World	HGCC	225D	Campus Engagement	Introductory
1:00 p.m.	2:15 p.m.	Students in the Food Movement: A Vision Deeper than the Problem	HGCC	221A	Food & Dining	Introductory
1:00 p.m.	2:15 p.m.	Advancing the Green Building Movement through Community Action & Learning	HGCC	221B	Buildings	Intermediate
1:00 p.m.	2:15 p.m.	Student Movements: How to Inform, Inspire, and Mobilize Diverse Student Populations to Catalyze Change	HGCC	221C	Campus Engagement	Intermediate
1:00 p.m.	2:15 p.m.	Lead your school to carbon neutrality and 100% renewable energy.	HGCC	225A	Campus Engagement	Introductory
1:00 p.m.	2:15 p.m.	Networks as a Tool for Social Change	HGCC	225B	Coordination & Planning	Introductory
1:00 p.m.	2:15 p.m.	Galvanizing Student Power for Intersectional Sustainability Efforts	HGCC	225C	Campus Engagement	Intermediate
2:30 p.m.	3:00 p.m.	Food Security Initiatives at Arizona State University	HGCC	221A	Food & Dining	Intermediate
2:30 p.m.	3:00 p.m.	Sustainability Ambassadors: Modeling a Culture of Sustainability at New Student Orientation	HGCC	221B	Campus Engagement	Introductory
2:30 p.m.	3:00 p.m.	Greeks Going Green: How and Why to Foster a Lasting Green Greek Life	HGCC	221C	Campus Engagement	Introductory
2:30 p.m.	3:00 p.m.	Know Your Impact: Guide to Environmentally Conscious Community Development	HGCC	225A	Campus Engagement	Introductory
2:30 p.m.	3:00 p.m.	Sustainability Council-- Collaboration Among Student Organizations Is Key to Sustainable Success at Ohio State	HGCC	225B	Campus Engagement	Intermediate
2:30 p.m.	3:00 p.m.	Building an Intersectionality Coalition: Listen, Organize, Act.	HGCC	225C	Campus Engagement	Introductory
3:15 p.m.	4:30 p.m.	Featured Session: The Drivers Behind Edible Food Recovery Programs at Institutions of Higher Education	HGCC	225B	Food & Dining	Introductory
3:15 p.m.	4:30 p.m.	Featured Session: Relocating Education for Sustainability: From the campus to the community	HGCC	225D	Public Engagement	Introductory
3:15 p.m.	4:30 p.m.	Student-led community food access initiative	HGCC	221A	Food & Dining	Introductory
3:15 p.m.	4:30 p.m.	Helping Students Gain Sustainability Project-Based Leadership Skills to be Competitive in the Job Market	HGCC	221B	Campus Engagement	Intermediate
3:15 p.m.	4:30 p.m.	How to Build Strategic Power -- Seven Secrets for Leaders to Win Change On & Beyond Campus	HGCC	221C	Campus Engagement	Intermediate
3:15 p.m.	4:30 p.m.	Saying No and Saying Yes: The Strategy of Campus Climate Activism	HGCC	225A	Public Engagement	Introductory
3:15 p.m.	4:30 p.m.	Stay Rad(ical) Post Grad	HGCC	225C	Wellbeing & Work	Introductory
(\$ Pre-Conference Workshops						
7:45 a.m.	4:30 p.m.	CURC Campus Recycling Workshop (\$) - bus leaves at 7:45 from HGCC	HGCC	Main Lobby	Waste	Introductory
8:30 a.m.	4:30 p.m.	To Come Together, We Must Transform What's Divided Us: Utilizing a Social Justice Lens for Collective Campus Sustainability Work (\$)	HGCC	221D	Diversity & Affordability	Intermediate

Start Time	End Time	Event Title	Location	Room	Primary Track	Sess. Level
8:30 a.m.	4:30 p.m.	Flow State Organizations: Organizational Design for Sustainability (\$)	HGCC	223	Campus Engagement	Advanced
8:30 a.m.	4:30 p.m.	5th AASHE Workshop on Research for Sustainability: 'Big Data' for Sustainability Research (\$)	RC	Conf. Room 10	Research	Intermediate
8:30 a.m.	4:30 p.m.	Facilitation for Organizational Change (\$)	RC	Conf. Room 12	Coordination & Planning	Advanced
8:30 a.m.	4:30 p.m.	Secrets to Campus Energy Success: Constructing a Comprehensive Renewable Energy Strategy (\$)	RC	Conf. Room 13	Energy	Intermediate
8:30 a.m.	4:30 p.m.	Learning the Language of Executive Leadership to Increase Sustainability's Value (\$)	RC	Conf. Room 18	Coordination & Planning	Advanced
8:30 a.m.	12:00 p.m.	Applied learning for sustainability projects: Developing high impact student-community collaborations (\$)	RC	Conf. Room 11	Curriculum	Introductory
8:30 a.m.	12:00 p.m.	Integrating Sustainability Across Disciplines: A Step-wise Process for (Re)designing a Syllabus (\$)	RC	Conf. Room 14	Curriculum	Intermediate
8:30 a.m.	12:00 p.m.	Gaining Hope and Resilience During Troubling Times (\$)	RC	Conf. Room 15	Wellbeing & Work	Introductory
8:30 a.m.	12:00 p.m.	Energy Engineering for Non-Engineers (\$)	RC	Conf. Room 16	Energy	Intermediate
8:30 a.m.	12:00 p.m.	Sustainability, Diversity, Equity and Inclusion Across the Curriculum (\$)	RC	Conf. Room 17	Diversity & Affordability	Introductory
1:00 p.m.	4:30 p.m.	Multiple Approaches to Successfully Sustaining Your Campus as a Teaching and Living Laboratory (\$)	RC	Conf. Room 11	Coordination & Planning	Intermediate
1:00 p.m.	4:30 p.m.	Sustainability Competencies: What are They, how to Address Them in Sustainability Courses, and how to Assess Students' Learning (\$)	RC	Conf. Room 14	Curriculum	Introductory
1:00 p.m.	4:30 p.m.	Supporting Students' Sustainability Learning and Emotional Resilience with Reflection and Contemplation (\$)	RC	Conf. Room 15	Curriculum	Introductory
1:00 p.m.	4:30 p.m.	Leading High-Functioning and Resilient Sustainability Offices - Making a difference via practical and effective leadership (\$)	RC	Conf. Room 16	Coordination & Planning	Intermediate

Sunday Afternoon and Evening Events

4:45 p.m.	6:00 p.m.	Opening Keynote - Katharine Hayhoe	HGCC	Stars at Night Ballroom		
6:00 p.m.	8:00 p.m.	Expo Hall Opening Reception	HGCC	Exhibit Hall 1		
6:00 p.m.	6:20 p.m.	Mentor Meet Up	HGCC	221A		

Monday, 10/16/17

7:30 a.m.	5:00 p.m.	Registration Open - Monday	HGCC	Main Lobby		
7:20 a.m.	8:00 a.m.	Yoga: Find calm and balance	RC	Conf. Room 8	Wellbeing & Work	Introductory
7:30 a.m.	8:15 a.m.	State of the Association Address: AASHE Member Meeting	HGCC	223		

Session A (8:30 a.m. 9:00 a.m.) 30-minute Sessions

8:30 a.m.	9:00 a.m.	Featured Session: Bridging the Gap Between Economic Viability and Environmental Sustainability with Solar on University Campuses	HGCC	221A	Energy	Introductory
8:30 a.m.	9:00 a.m.	Ten Years of Including Wellness in the Sustainability Model	HGCC	223	Wellbeing & Work	Intermediate
8:30 a.m.	9:00 a.m.	Leveraging AASHE STARS for Organizational Change	HGCC	221B	Coordination & Planning	Introductory
8:30 a.m.	9:00 a.m.	From Sustainable Development Goals to Campus Sustainability Plan	HGCC	221C	Coordination & Planning	Introductory
8:30 a.m.	9:00 a.m.	Campus Sustainability Reporting and WikiRate	HGCC	221D	Coordination & Planning	Intermediate
8:30 a.m.	9:00 a.m.	Women & Sustainability: Utilizing a Year-long Theme to Enhance your Sustainability Initiatives	HGCC	225A	Diversity & Affordability	Introductory
8:30 a.m.	9:00 a.m.	Lean Green Financing at MSIs	HGCC	225B	Investment & Finance	Introductory
8:30 a.m.	9:00 a.m.	Building Bridges to Conservative Students to Build Support for Climate Action and Enrich Campus Conversations	HGCC	225C	Campus Engagement	Introductory
8:30 a.m.	9:00 a.m.	Motivating Students to Achieve 20% Electricity and Hot Water Savings in Campus Apartments	HGCC	225D	Campus Engagement	Intermediate
8:30 a.m.	9:00 a.m.	Community sustainability partnerships: How to stimulate millions in local green investment and expand your program's visibility and impact	RC	Conf. Room 10	Public Engagement	Intermediate
8:30 a.m.	9:00 a.m.	From the Iowa Caucus to the Iowa State House: Strategies for Sustained Civic Engagement	RC	Conf. Room 11	Public Engagement	Introductory
8:30 a.m.	9:00 a.m.	Community Partnerships for Environmental Justice	RC	Conf. Room 12	Public Engagement	Introductory
8:30 a.m.	9:00 a.m.	Lorax 2.0: Twenty Questions for Standing in Solidarity with Living Systems in Sustainability Research in Higher Education	RC	Conf. Room 13	Research	Introductory
8:30 a.m.	9:00 a.m.	Building Our Capacity for Taking Action Together	RC	Conf. Room 14	Curriculum	Introductory
8:30 a.m.	9:00 a.m.	Visual Art and Poetry in Environmental Education	RC	Conf. Room 15	Curriculum	Intermediate
8:30 a.m.	9:00 a.m.	Breaking Boundaries in Sustainability Education	RC	Conf. Room 16	Curriculum	Intermediate
8:30 a.m.	9:00 a.m.	Using the SDGs to progress sustainability	RC	Conf. Room 17	Campus Engagement	Introductory
8:30 a.m.	9:00 a.m.	Bees on Campus: Student Engagement in Sustainable Practices	RW	Bonham	Coordination & Planning	Introductory
8:30 a.m.	9:00 a.m.	Closed Loop Food System at Warren Wilson College	RW	Bowie	Food & Dining	Introductory
8:30 a.m.	9:00 a.m.	The Solo Cup Challenge: Waste Less, Raise More	RW	Salon A	Waste	Introductory

Start Time	End Time	Event Title	Location	Room	Primary Track	Sess. Level
8:30 a.m.	9:00 a.m.	RecycleMania's Race to Zero Waste	RW	Salon B	Waste	Intermediate
8:30 a.m.	9:00 a.m.	Offsetting University Travel Through Energy Efficiency on Campus	RW	Salon C	Air & Climate	Intermediate
8:30 a.m.	9:00 a.m.	Pareto principal for your carbon reduction goals: Purchasing offsite renewable energy while addressing stakeholder needs	RW	Salon D	Energy	Introductory
8:30 a.m.	9:00 a.m.	Net Zero 24/7: How Colorado College's 94k Square Foot Library Became a Carbon Reduction Strategy	RW	Salon E	Energy	Intermediate
8:30 a.m.	9:00 a.m.	Social Learning Platform and Collaborative Design Process for a Net Positive Outdoor Sustainability Learning Center	RW	Salon F	Buildings	Intermediate
8:30 a.m.	9:00 a.m.	Beyond Excuses: Banning Bottled Water on Your Campus	RW	Travis	Food & Dining	Introductory
Session B (9:15 a.m. - 10:15 a.m.): 60-minute Sessions						
9:15 a.m.	10:15 a.m.	Featured Session: Introducing the new STARS Peer Review Protocol	HGCC	221A	Coordination & Planning	Intermediate
9:15 a.m.	10:15 a.m.	Rookies, Newbies, Imposters, & Not-Yet-Experts: Navigating Newness, Isolation, and/or Competence for Sustainability Professionals in Higher Education	HGCC	221B	Coordination & Planning	Intermediate
9:15 a.m.	10:15 a.m.	Fundamentals of Project Management	HGCC	221C	Coordination & Planning	Introductory
9:15 a.m.	10:15 a.m.	Accelerating Sustainability Integration through Strategic Leadership	HGCC	221D	Coordination & Planning	Intermediate
9:15 a.m.	10:15 a.m.	Advancing Sustainability Through Health and Wellness Partnerships	HGCC	223	Wellbeing & Work	Intermediate
9:15 a.m.	10:15 a.m.	An Introduction to the Role of Race, Class and Gender Issues On Campus Sustainability Work	HGCC	225A	Diversity & Affordability	Introductory
9:15 a.m.	10:15 a.m.	Next Generation Campus Green Funds	HGCC	225B	Investment & Finance	Introductory
9:15 a.m.	10:15 a.m.	Promoting Sustainability & Sustainable Behaviors: Real-World Challenges	HGCC	225C	Campus Engagement	Introductory
9:15 a.m.	10:15 a.m.	Cultivating Student Sustainability Leadership	HGCC	225D	Campus Engagement	Introductory
9:15 a.m.	10:15 a.m.	Growing Healthy Kids: The Intersection of Health, Justice, and Sustainability	RC	Conf. Room 10	Public Engagement	Intermediate
9:15 a.m.	10:15 a.m.	Sustainability Summer Camps on Campus	RC	Conf. Room 11	Public Engagement	Introductory
9:15 a.m.	10:15 a.m.	Nourishing U: Reclaiming Food, Alleviating Hunger, Redressing Health Inequities, and Serving up Food Justice	RC	Conf. Room 12	Public Engagement	Intermediate
9:15 a.m.	10:15 a.m.	Beyond the Triple Bottom Line; An Alternative Framework for Sustainability	RC	Conf. Room 13	Research	Intermediate
9:15 a.m.	10:15 a.m.	Featuring the Chemistry Department in Campus Sustainability Initiatives: Best Practices in the Lab and Curriculum	RC	Conf. Room 14	Curriculum	Introductory
9:15 a.m.	10:15 a.m.	Using Contemplative Practices to Cultivate Resilient Students and Social-Ecological Systems	RC	Conf. Room 15	Curriculum	Advanced
9:15 a.m.	10:15 a.m.	Advancing ESD Curriculum Development & Faculty Development through a Consortium Approach	RC	Conf. Room 16	Curriculum	Advanced
9:15 a.m.	10:15 a.m.	Finding the Sustainability Sweet Spot: Where Operations and Education Converge	RC	Conf. Room 17	Campus Engagement	Introductory
9:15 a.m.	10:15 a.m.	Building a Culture of Sustainability through New Student Orientation	RC	Conf. Room 18	Campus Engagement	Introductory
9:15 a.m.	10:15 a.m.	Valuing and Conserving College Land for Community Resilience	RW	Bonham	Coordination & Planning	Intermediate
9:15 a.m.	10:15 a.m.	The Ripple Effect: Taking Hydroponic Growing From Missouri State to 32 Other Schools and Eventually the World	RW	Bowie	Food & Dining	Intermediate
9:15 a.m.	10:15 a.m.	The Zero Waste Challenge: Utilizing Athletic Events to Pave the Way	RW	Salon A	Waste	Introductory
9:15 a.m.	10:15 a.m.	Learnings in Advancing Sustainability, Measuring Progress, and Keeping Campus Clean with Smart Waste & Recycling Solutions	RW	Salon B	Waste	Introductory
9:15 a.m.	10:15 a.m.	Getting Started with Local Carbon Offsets: Spotlight on Urban Forestry	RW	Salon C	Air & Climate	Intermediate
9:15 a.m.	10:15 a.m.	Getting Traction with Large-Scale Renewable Energy Procurement: Finding Your Sweet-Spot and Effectively Communicating About It	RW	Salon D	Energy	Intermediate
9:15 a.m.	10:15 a.m.	Students Counting Kilowatts - Student-engagement in energy conservation and master planning	RW	Salon E	Energy	Intermediate
9:15 a.m.	10:15 a.m.	By Impacting Hearts and Minds, Emergent Leadership Transforms Brick and Mortar Projects Into Much More.	RW	Salon F	Buildings	Introductory
9:15 a.m.	10:15 a.m.	Tackling the Supply Chain - Proven Strategies to Source More Sustainable Food	RW	Travis	Food & Dining	Introductory
9:15 a.m.	10:15 a.m.	Beyond Policy: Sustainable Catering at an Institutional Level	RW	Valero	Purchasing	Intermediate
10:15 a.m.	10:45 a.m.	Coffee / Networking Break	HGCC	Exhibit Hall 1		
Session C (10:45 a.m. - 11:15 a.m.): 30-minute Sessions						
10:45 a.m.	11:15 a.m.	Featured Session: Getting to Zero: Integrating Carbon Neutrality Planning with a Campus Utility Master Plan at a Small Liberal Arts College	HGCC	221A	Energy	Advanced
10:45 a.m.	11:15 a.m.	Featured Session: The Nitrogen Footprint Tool Network: A Multi-Institution Program to Research and Reduce Nitrogen Pollution	HGCC	221C	Coordination & Planning	Introductory
10:45 a.m.	11:15 a.m.	The Road to Gold: Sustainability Success REALLY IS Written in the STARS	HGCC	221B	Coordination & Planning	Introductory
10:45 a.m.	11:15 a.m.	Examining the Uptake of Sustainability in Canadian Higher Education Institutions: A Comparative Case Study	HGCC	221D	Coordination & Planning	Intermediate
10:45 a.m.	11:15 a.m.	Beyond BikeShare: Sustainable Transportation in Six Months of Winter	HGCC	223	Transportation	Intermediate

Start Time	End Time	Event Title	Location	Room	Primary Track	Sess. Level
10:45 a.m.	11:15 a.m.	Building Community through Intergroup Dialogue	HGCC	225A	Diversity & Affordability	Intermediate
10:45 a.m.	11:15 a.m.	From Divestment to Reinvestment?	HGCC	225B	Investment & Finance	Intermediate
10:45 a.m.	11:15 a.m.	High Priests of Sustainability?! The Promise and Perils of Becoming Your School's Moral Compass	HGCC	225C	Campus Engagement	Intermediate
10:45 a.m.	11:15 a.m.	Building a Public Institution Sustainability Program from the Ground Up: Ethics, Accolades and Advertising.	HGCC	225D	Campus Engagement	Intermediate
10:45 a.m.	11:15 a.m.	Advancing Innovation through Sustainability Research and Scholarship	RC	Conf. Room 10	Public Engagement	Intermediate
10:45 a.m.	11:15 a.m.	Activities on campus sustainability for solidarity in Japan - A Case Study: The Green Program in Fukushima -	RC	Conf. Room 11	Public Engagement	Intermediate
10:45 a.m.	11:15 a.m.	The Power of One: How a Physics Professor Saved Italy from Big Oil Through Education, Activism and Community Outreach	RC	Conf. Room 12	Public Engagement	Intermediate
10:45 a.m.	11:15 a.m.	Oral History and Sustainability: Campus and Community Engagement Through Student Research in the Humanities	RC	Conf. Room 13	Research	Introductory
10:45 a.m.	11:15 a.m.	Student Learning Outcomes in Sustainability Education: Faculty Participation and Measured Student Learning	RC	Conf. Room 14	Curriculum	Intermediate
10:45 a.m.	11:15 a.m.	Faculty Learning Communities for Sustainability	RC	Conf. Room 15	Curriculum	Introductory
10:45 a.m.	11:15 a.m.	Tweeting @Sustainability: The #447challenge as an Active Teaching Tool	RC	Conf. Room 16	Curriculum	Intermediate
10:45 a.m.	11:15 a.m.	Motivating and Quantifying the Impacts of Behavior Change	RC	Conf. Room 17	Campus Engagement	Intermediate
10:45 a.m.	11:15 a.m.	Refillable water bottles, reusable bags, and bicycle lights: Is sustainability swag sustainable?	RC	Conf. Room 18	Campus Engagement	Introductory
10:45 a.m.	11:15 a.m.	Disruptive Tech: Beyond Net Zero Energy Onsite Water Reuse	RW	Bonham	Water	Introductory
10:45 a.m.	11:15 a.m.	Campus Gardens: Increasing Sustainability and Lowering Food Insecurity	RW	Bowie	Food & Dining	Introductory
10:45 a.m.	11:15 a.m.	Transforming a Campus for Zero Waste by Focusing on People	RW	Salon A	Waste	Intermediate
10:45 a.m.	11:15 a.m.	Sustainable Campus Competition LIVE!: How \$50,000 Created a Replicable Model for Citywide Composting	RW	Salon B	Waste	Intermediate
10:45 a.m.	11:15 a.m.	Carbon Footprint of Higher Education	RW	Salon C	Air & Climate	Advanced
10:45 a.m.	11:15 a.m.	Power in Numbers: Collaborative Solar Procurement in Virginia	RW	Salon D	Energy	Intermediate
10:45 a.m.	11:15 a.m.	California's Campuses Light the Way to a Clean Energy Future: Best Practices in Solar Project Planning	RW	Salon E	Energy	Intermediate
10:45 a.m.	11:15 a.m.	Sustainable Living: Off-Grid Tiny Hydro Powered House	RW	Salon F	Buildings	Introductory
10:45 a.m.	11:15 a.m.	Meatless Monday on Campus: How to VEG (or BEEF) up Your Campus Sustainability Efforts by Connecting to Students Through Food	RW	Travis	Food & Dining	Intermediate
10:45 a.m.	11:15 a.m.	A New Way to Benchmark Your Sustainable Purchasing Program	RW	Valero	Purchasing	Intermediate
Session D (11:30 a.m. - 12:30 p.m.): 60-minute Sessions						
11:30 a.m.	12:30 p.m.	Featured Session: Beyond Interpersonal Competence: Teaching and Learning Professional Skills in Sustainability	HGCC	221A	Curriculum	Introductory
11:30 a.m.	12:30 p.m.	Featured Session: Fix It Friday	HGCC	225B	Campus Engagement	Introductory
11:30 a.m.	12:30 p.m.	Featured Session: A comparative study of the efficacy of intervention strategies on student electricity use in campus residence halls	RC	Conf. Room 10	Public Engagement	Introductory
11:30 a.m.	12:30 p.m.	Dismantling the Economic Walls Within: Why Solidarity is Necessary for Living Wage Policies in Higher Education	HGCC	223	Wellbeing & Work	Intermediate
11:30 a.m.	12:30 p.m.	AASHE Stars as a Framework for Sustainability Master Planning: Purdue University	HGCC	221B	Coordination & Planning	Advanced
11:30 a.m.	12:30 p.m.	Facilitating Urban Climate Resilience Planning: Experiences from 3 Cities	HGCC	221C	Coordination & Planning	Introductory
11:30 a.m.	12:30 p.m.	Breaking Through the "Green Ceiling": Sustainability as a Path to Executive Leadership	HGCC	221D	Coordination & Planning	Advanced
11:30 a.m.	12:30 p.m.	Brave Together: Learning What We Don't Know About Diversity	HGCC	225A	Diversity & Affordability	Intermediate
11:30 a.m.	12:30 p.m.	Greeks Go Green: Engaging the Collegiate Greek Community in Sustainable Practices	HGCC	225C	Campus Engagement	Introductory
11:30 a.m.	12:30 p.m.	Organizing for Sustainability: How Student Sustainability Groups Make a Difference	HGCC	225D	Campus Engagement	Introductory
11:30 a.m.	12:30 p.m.	We Are Still In! Using the STAR Community Rating Framework to Strengthen Your Community Outreach Efforts on Climate and Sustainability	RC	Conf. Room 11	Public Engagement	Intermediate
11:30 a.m.	12:30 p.m.	From the Southeast to the UN: Reflections from GA & SC on Applying for and Launching New Regional Centres of Expertise	RC	Conf. Room 12	Public Engagement	Introductory
11:30 a.m.	12:30 p.m.	Let's Develop a Sustainability Literacy Assessment!	RC	Conf. Room 13	Research	Intermediate
11:30 a.m.	12:30 p.m.	Incorporating Sustainability in Traditional Writing and Humanities Courses	RC	Conf. Room 14	Curriculum	Introductory
11:30 a.m.	12:30 p.m.	Teaching Climate Change Across the Curriculum	RC	Conf. Room 15	Curriculum	Introductory
11:30 a.m.	12:30 p.m.	Best Practices Incorporating Sustainability into the Curricula/ Dallas County Community College District	RC	Conf. Room 16	Curriculum	Introductory
11:30 a.m.	12:30 p.m.	The Sulitest: How to Raise Awareness and Assess Sustainability Literacy Worldwide?	RC	Conf. Room 17	Curriculum	Introductory
11:30 a.m.	12:30 p.m.	Prioritizing Sustainable Learning	RC	Conf. Room 18	Curriculum	Introductory
11:30 a.m.	12:30 p.m.	Food Service Companies and Campuses Innovating to Source More Local Food	RW	Bowie	Food & Dining	Introductory
11:30 a.m.	12:30 p.m.	Beyond Diversion - Finding Better Tools to Measure Zero Waste	RW	Salon A	Waste	Intermediate
11:30 a.m.	12:30 p.m.	Food Waste Interventions	RW	Salon B	Waste	Introductory

Start Time	End Time	Event Title	Location	Room	Primary Track	Sess. Level
11:30 a.m.	12:30 p.m.	Bundled Offsets: Manage Risk and Benefit Local Communities	RW	Salon C	Air & Climate	Intermediate
11:30 a.m.	12:30 p.m.	Innovative Financing Options and the University Solar Deployment Process	RW	Salon D	Energy	Introductory
11:30 a.m.	12:30 p.m.	Free, Open Source Energy Dashboard: A Platform for Collaboration Between Students, Faculty, and Facilities Management	RW	Salon E	Energy	Intermediate
11:30 a.m.	12:30 p.m.	North Carolina State University: Performance, LEED, and the Arc Platform	RW	Salon F	Buildings	Intermediate
11:30 a.m.	12:30 p.m.	Plants on the Plate: Meeting Student Demand for Sustainable Plant-Based Dining.	RW	Travis	Food & Dining	Introductory
11:30 a.m.	12:30 p.m.	Interactive Workshop: Simple Choices in Sustainable Purchasing? Beware the Pitfalls	RW	Valero	Purchasing	Intermediate
12:30 p.m.	3:00 p.m.	Lunch n' Learn with Exhibitors (lunch served 12:30-2:00)	HGCC	Exhibit Hall 1		
1:00 p.m.	1:30 p.m.	AGREENOZZI Presents "Learn How to Integrate Reusable Sustainability with Operational Intelligence"	HGCC	Exhibitor Showcase	Waste	Introductory
2:00 p.m.	2:30 p.m.	Sultitest Presents "The Updated Sustainability Literacy Test"	HGCC	Exhibitor Showcase	Curriculum	Introductory
1:30 p.m.	3:00 p.m.	STARS Clinic	HGCC	Exhibit Hall 1	STARS	Introductory
3:00 p.m.	4:30 p.m.	Poster Session with Refreshments	HGCC	Exhibit Hall 1		
Networking Meetings (4:45 p.m. - 5:45 p.m.)						
4:45 p.m.	5:45 p.m.	New York Coalition for Sustainability in Higher Education networking meeting	HGCC	221B	Coordination & Planning	Introductory
4:45 p.m.	5:45 p.m.	AASHE Advisory Council Meeting	HGCC	221C		
4:45 p.m.	5:45 p.m.	Rookies, Newbies, Imposters, & Not-Yet-Experts: Navigating Newness, Isolation, and/or Competence for Sustainability Professionals in Higher Education	HGCC	221D	Coordination & Planning	Intermediate
4:45 p.m.	5:45 p.m.	Community College Networking Meeting	RC	223	Campus Engagement	Introductory
4:45 p.m.	5:45 p.m.	AASHE International Networking Meeting	HGCC	225A	Coordination & Planning	Intermediate
4:45 p.m.	5:45 p.m.	Student Affairs Networking Presentation	HGCC	225B	Campus Engagement	Introductory
4:45 p.m.	5:45 p.m.	EcoReps Programs Nation-wide - Networking for every program type	HGCC	225C	Campus Engagement	Intermediate
4:45 p.m.	5:45 p.m.	Bridging the Gap: Strategies for Sustainability-Athletics Partnerships	HGCC	225D	Campus Engagement	Introductory
4:45 p.m.	5:45 p.m.	Arizona Tri-University Meet and Greet.	RC	Conf. Room 12	Coordination & Planning	Introductory
4:45 p.m.	5:45 p.m.	Building a community of practice for applied learning for sustainability practitioners	RC	Conf. Room 14	Curriculum	Introductory
4:45 p.m.	5:45 p.m.	Re-generation: Regenerate, Renew, and Refresh - Preparing Our Students to Lead	RC	Conf. Room 15	Coordination & Planning	Advanced
4:45 p.m.	5:45 p.m.	Academicians: How to Teach with Paul Hawken's 'DrawDown: The Most Comprehensive Plan Ever Proposed to Reverse Global Warming'	RC	Conf. Room 16	Curriculum	Advanced
4:45 p.m.	5:45 p.m.	Laudato si? Catholic College and Universities Networking Session	HGCC	Conf. Room 17	Campus Engagement	Introductory
4:45 p.m.	5:45 p.m.	Texas Regional Alliance for Campus Sustainability (TRACS) Networking Session	RC	Conf. Room 18	Campus Engagement	Introductory
4:45 p.m.	5:45 p.m.	Ivy+ Sustainability Consortium - by invitation only	RW	Bowie	Coordination & Planning	Intermediate
4:45 p.m.	5:45 p.m.	Working Together Towards Zero Waste	RW	Salon B	Waste	Introductory
4:45 p.m.	5:45 p.m.	Climate Leadership Commitment Signatory Networking Session	RW	Salon C	Air & Climate	Advanced
4:45 p.m.	5:45 p.m.	Real Food Challenge: Making Real Food a Reality on Campus	RW	Travis	Food & Dining	Intermediate
4:45 p.m.	5:45 p.m.	Transportation Networking Meeting	RW	Valero	Transportation	Introductory
Monday Evening Events						
6:30 p.m.	9:30 p.m.	The AASHE Epic Not-working Event for Change Agents (\$)	HGCC	Main Lobby	Coordination & Planning	Advanced
7:30 p.m.	10:00 p.m.	Special Movie Screening: How to Let Go of the World and Love All the Things Climate Can't Change	HGCC	Stars at Night Ballroom		
Tuesday, 10/17/17						
7:30 a.m.	3:30 p.m.	Registration Open - Tuesday	HGCC	Main Lobby		
7:20 a.m.	8:00 a.m.	Yoga: Find calm and balance	RC	Conf. Room 8	Wellbeing & Work	Introductory
Session E (8:30 a.m. - 9:00 a.m.): 30-minute Sessions						
8:30 a.m.	9:00 a.m.	Featured Session: Development of a Sustainability Culture Assessment to Inform Planning	HGCC	221A	Campus Engagement	Introductory
8:30 a.m.	9:00 a.m.	Campus All-STARs: a model for streamlining reporting, improving performance, and creating synergies to advance sustainability	HGCC	221B	Coordination & Planning	Introductory
8:30 a.m.	9:00 a.m.	Models for Collaborative and Implementable Pan-Campus Sustainability Plans	HGCC	221C	Coordination & Planning	Advanced

Start Time	End Time	Event Title	Location	Room	Primary Track	Sess. Level
8:30 a.m.	9:00 a.m.	Passing the Baton: Best Practices for Transitioning Into and Out of Sustainability Positions	HGCC	221D	Coordination & Planning	Intermediate
8:30 a.m.	9:00 a.m.	Learning for Sustainability Core Competencies Through an Evidence Based Internship Program	HGCC	223	Campus Engagement	Intermediate
8:30 a.m.	9:00 a.m.	Finding Your Voice: Understanding Otherness in Sustainability Education	HGCC	225A	Diversity & Affordability	Intermediate
8:30 a.m.	9:00 a.m.	Dollars are Flying out of Your Green Fund! Does That Equal Success?	HGCC	225B	Investment & Finance	Intermediate
8:30 a.m.	9:00 a.m.	Unifying Campus Audiences in Co-Curricular Sustainability Programming to Create Action-Oriented Projects	HGCC	225C	Campus Engagement	Intermediate
8:30 a.m.	9:00 a.m.	Needed: Systemic Change and Collaboration to Confront Shared Challenges - PepsiCo, UC Boulder, and other Universities break new	HGCC	225D	Campus Engagement	Introductory
8:30 a.m.	9:00 a.m.	Sonified Sustainability: Building Deeper Green Coalitions	RC	Conf. Room 10	Campus Engagement	Introductory
8:30 a.m.	9:00 a.m.	Refugee Resettlement in Northern Colorado: A Social Sustainability Story	RC	Conf. Room 11	Public Engagement	Introductory
8:30 a.m.	9:00 a.m.	George Washington University Fostering Federal Sustainability	RC	Conf. Room 12	Public Engagement	Introductory
8:30 a.m.	9:00 a.m.	Rapid Response: The South Carolina Floods Research Initiative	RC	Conf. Room 13	Research	Intermediate
8:30 a.m.	9:00 a.m.	Integrating Sustainability Learning Outcomes Into a University Curriculum - A Case Study of Institutional Dynamics	RC	Conf. Room 14	Curriculum	Introductory
8:30 a.m.	9:00 a.m.	Implementing an Environmental Sustainability Badge Program: Best Practices for Co-Curricular Learning and Community Engagement	RC	Conf. Room 15	Curriculum	Intermediate
8:30 a.m.	9:00 a.m.	A Classroom of 'Cultural Creatives'? A Values-Based Approach to Teaching About Sustainable Societies	RC	Conf. Room 16	Curriculum	Intermediate
8:30 a.m.	9:00 a.m.	Building Blocks for Assessing the Impact of Energy Dashboards	RC	Conf. Room 17	Campus Engagement	Intermediate
8:30 a.m.	9:00 a.m.	Sustaining Food and Housing Insecure Students on College Campuses	RC	Conf. Room 18	Campus Engagement	Introductory
8:30 a.m.	9:00 a.m.	Readdressing Environmental Thinking in Residence Hall Design	RW	Bonham	Buildings	Intermediate
8:30 a.m.	9:00 a.m.	Green-to-Green Project: Economic Empowerment through Sustainable Agriculture	RW	Bowie	Food & Dining	Introductory
8:30 a.m.	9:00 a.m.	Achieving Campus Waste Goals by Leveraging Diverse Stakeholders on and off Campus	RW	Salon A	Waste	Intermediate
8:30 a.m.	9:00 a.m.	Throwing in the Towel: Lessons Learned from Launching a Paper Towel Compost Program	RW	Salon B	Waste	Intermediate
8:30 a.m.	9:00 a.m.	Utilizing Innovative and Peer Reviewed Carbon Offsets with the Second Nature Climate Leadership Commitments	RW	Salon C	Air & Climate	Intermediate
8:30 a.m.	9:00 a.m.	The Growth of Renewable Energy in Higher Education: Can It Get Us to Our GHG Goals?	RW	Salon D	Energy	Intermediate
8:30 a.m.	9:00 a.m.	Leveraging ENERGY STAR to Increase Campus Efficiency: A Northwestern University Case Study	RW	Salon E	Campus Engagement	Intermediate
8:30 a.m.	9:00 a.m.	Ecovillage + Innovation Village = The Future, now!	RW	Salon F	Buildings	Advanced
8:30 a.m.	9:00 a.m.	Mining STARS Data: Results & Lessons Learned From Quantitative Research Exploring Variation in Food/Beverage Purchasing Scores	RW	Travis	Food & Dining	Intermediate
8:30 a.m.	9:00 a.m.	If You Build It, Will They Come? Creating a Biking Culture by Sharing	RW	Valero	Transportation	Introductory
Session F (9:15 a.m. - 10:15 a.m.): 60-minute Sessions						
9:15 a.m.	10:15 a.m.	Featured Session: Creating political will for climate action: the role of higher education	HGCC	221A	Public Engagement	Intermediate
9:15 a.m.	10:15 a.m.	A Guide to Using the new Campus Carbon and Nitrogen Footprint Tool	HGCC	221B	Coordination & Planning	Introductory
9:15 a.m.	10:15 a.m.	Sustainability Planning: Year One Into Implementation	HGCC	221C	Coordination & Planning	Introductory
9:15 a.m.	10:15 a.m.	Sustainability for Sustainability Professionals	HGCC	221D	Coordination & Planning	Advanced
9:15 a.m.	10:15 a.m.	Engaging Senior Leaders in Organizational Design and Idea Flow: Lessons learned from Corporate & Higher Education Sector Leaders	HGCC	223	Campus Engagement	Intermediate
9:15 a.m.	10:15 a.m.	The High Touch Approach: Making Inclusivity and Social Sustainability Core to Mission	HGCC	225A	Diversity & Affordability	Intermediate
9:15 a.m.	10:15 a.m.	Quadruple Bottom Line Analysis	HGCC	225B	Investment & Finance	Advanced
9:15 a.m.	10:15 a.m.	Athletics as a Resource for Advancing Campus Sustainability Goals	HGCC	225C	Campus Engagement	Introductory
9:15 a.m.	10:15 a.m.	Sustainability and the Arts	HGCC	225D	Campus Engagement	Introductory
9:15 a.m.	10:15 a.m.	Engaging Tech-Savvy Students in Curricular and Co-Curricular Sustainability Programs for Social and Environmental Change	RC	Conf. Room 10	Campus Engagement	Introductory
9:15 a.m.	10:15 a.m.	Using Compost to Seek Green Justice Beyond the Campus	RC	Conf. Room 11	Public Engagement	Introductory
9:15 a.m.	10:15 a.m.	What Paper Manufacturers Know About Environmental Impact that Customers Aren't Asking About	RC	Conf. Room 12	Purchasing	Introductory
9:15 a.m.	10:15 a.m.	Using Sustainability-Themed Undergraduate Research Programs to Enhance Student Engagement in Research	RC	Conf. Room 13	Research	Intermediate
9:15 a.m.	10:15 a.m.	Better Together: Using an S Designation to Create Visible, Coherent, Trans-disciplinary Curriculum Out of What You Already Have	RC	Conf. Room 14	Curriculum	Intermediate
9:15 a.m.	10:15 a.m.	Sustainability skills - what are they? And how do we know students have them...	RC	Conf. Room 15	Curriculum	Intermediate
9:15 a.m.	10:15 a.m.	Influences of Student Sustainability Literacy in a University Setting, A Dissertation Study	RC	Conf. Room 16	Curriculum	Advanced
9:15 a.m.	10:15 a.m.	Longitudinal Sustainability Literacy and Culture Assessment for Students, Faculty, and Staff - Lessons Learned and Results	RC	Conf. Room 17	Campus Engagement	Advanced

Start Time	End Time	Event Title	Location	Room	Primary Track	Sess. Level
9:15 a.m.	10:15 a.m.	Communicating Sustainability Through Social Media	RC	Conf. Room 18	Campus Engagement	Introductory
9:15 a.m.	10:15 a.m.	Reuse or Build New? A Tale of Two Carbon Footprints	RW	Bonham	Buildings	Intermediate
9:15 a.m.	10:15 a.m.	Best Practices for Supporting Campus Food Security	RW	Bowie	Food & Dining	Introductory
9:15 a.m.	10:15 a.m.	Comparing Move Out Programs: Sharing Perspectives on Waste Diversion, Campus & Community Collaboration, & Sustainability Goals.	RW	Salon A	Waste	Intermediate
9:15 a.m.	10:15 a.m.	Compost and Collaboration: Reaching Zero Waste at UCI in Dining Commons and Residence Halls	RW	Salon B	Waste	Intermediate
9:15 a.m.	10:15 a.m.	Riverbank Climate Collaboration: How MIT and BU are preparing for Climate Change from Both Sides of the River	RW	Salon C	Air & Climate	Introductory
9:15 a.m.	10:15 a.m.	From Gown to Town: Bringing the Benefits of Solar Energy to the Community	RW	Salon D	Energy	Intermediate
9:15 a.m.	10:15 a.m.	Developing Carbon Credits on Your Campus through the Voluntary Carbon Market	RW	Salon E	Energy	Intermediate
9:15 a.m.	10:15 a.m.	Submetering: Identify, Integrate, Fix and Cruise	RW	Salon F	Buildings	Advanced
9:15 a.m.	10:15 a.m.	A Journey to Real Food: Growing an Intersectional Food Movement through Student Involvement and Empowerment	RW	Travis	Food & Dining	Introductory
9:15 a.m.	10:15 a.m.	Nudging commuters, big data and bold partnerships: A research-based approach to impacting commuter mode choice at MIT	RW	Valero	Transportation	Intermediate
10:00 a.m.	2:00 p.m.	Meet AASHE Exhibitors!	HGCC	Exhibit Hall 1		
10:30 a.m.	12:00 p.m.	STARS Clinic	HGCC	Exhibit Hall 1	STARS	Introductory
12:00 p.m.	2:00 p.m.	Lunch n' Learn with Exhibitors (lunch served 12:00-2:00)	HGCC	Exhibit Hall 1		
1:00 p.m.	1:30 p.m.	RRS Presents "Sort it Out: Learn the Benefits of a Waste Sort LIVE"	HGCC	Exhibitor Showcase	Waste	Introductory
Networking Meetings (12:45 p.m. - 1:45 p.m.)						
12:45 p.m.	1:45 p.m.	STARS Town Hall	HGCC	221B	Coordination & Planning	Intermediate
12:45 p.m.	1:45 p.m.	Northeast Campus Sustainability Consortium (NECSC)	HGCC	221C	Coordination & Planning	Introductory
12:45 p.m.	1:45 p.m.	Liberal Arts Institutions Networking Meeting	HGCC	221D	Campus Engagement	Introductory
12:45 p.m.	1:45 p.m.	Canadian Networking Session	HGCC	223	Public Engagement	Introductory
12:45 p.m.	1:45 p.m.	Diversity Social: Solidarity Can Be Fun!	HGCC	225A	Diversity & Affordability	Introductory
12:45 p.m.	1:45 p.m.	Engaging Students in Sustainable Living Without Social Media/Internet. Discussion for Sustainability Staff in Student Housing.	HGCC	225C	Campus Engagement	Intermediate
12:45 p.m.	1:45 p.m.	You Ask, We Answer: An Informal Conversation About How AASHE Membership Can Support Your Institution's Sustainability Goals	HGCC	225D	Campus Engagement	Introductory
12:45 p.m.	1:45 p.m.	St. Louis Higher Education Sustainability Consortium (and regional friends!) Meeting	RC	Conf. Room 10	Coordination & Planning	Intermediate
12:45 p.m.	1:45 p.m.	Managing for Triple-Bottom-Line Sustainability from the C-Suite to the Front Line Management Team	RC	Conf. Room 11	Coordination & Planning	Intermediate
12:45 p.m.	1:45 p.m.	Empowering Student Leadership in Tough Times	RC	Conf. Room 12	Campus Engagement	Intermediate
12:45 p.m.	1:45 p.m.	Centers for Sustainability Across the Curriculum Gathering - by invitation only	RC	Conf. Room 14		
12:45 p.m.	1:45 p.m.	Communications Networking Meeting	RC	Conf. Room 15	Campus Engagement	Introductory
12:45 p.m.	1:45 p.m.	Student Intern Program Managers	RC	Conf. Room 16	Campus Engagement	Introductory
12:45 p.m.	1:45 p.m.	Energizing Campuses & Communities Through More Meaningful and Applied Learning	RC	Conf. Room 17	Energy	Introductory
12:45 p.m.	1:45 p.m.	Campus Gardens and Farms: Creatively Addressing Food Insecurity	RW	Bowie	Food & Dining	Introductory
12:45 p.m.	1:45 p.m.	College & University Recycling Coalition (CURC) Membership Meeting	RW	Salon B	Waste	Intermediate
12:45 p.m.	1:45 p.m.	Climate Leadership Network Carbon Offset Projects Networking	RW	Salon C	Air & Climate	Introductory
12:45 p.m.	1:45 p.m.	Sub-Metering and Energy Dashboard Networking	RW	Salon E	Energy	Introductory
12:45 p.m.	1:45 p.m.	Less & Better Meat in University Dining Services	RW	Travis	Food & Dining	Intermediate
Session G (2:00 p.m. - 2:30 p.m.): 30-minute Sessions						
2:00 p.m.	2:30 p.m.	Presidential Power: Examining the Language of Executive Campus Commitments	HGCC	221B	Coordination & Planning	Intermediate
2:00 p.m.	2:30 p.m.	Emphasizing Diversity and Equity in Your Sustainability Narrative	HGCC	221C	Coordination & Planning	Intermediate
2:00 p.m.	2:30 p.m.	Significant Role of Universitas Indonesia GreenMetric World University Rankings on Supporting Sustainable Campus	HGCC	221D	Coordination & Planning	Introductory
2:00 p.m.	2:30 p.m.	Elevating Your Campus Sustainability Month	HGCC	223	Campus Engagement	Introductory
2:00 p.m.	2:30 p.m.	The Lending Library: Addressing Textbook Affordability and Reducing Waste	HGCC	225A	Diversity & Affordability	Introductory
2:00 p.m.	2:30 p.m.	The Future of Campus Mobility	HGCC	225B	Transportation	Introductory
2:00 p.m.	2:30 p.m.	Forming campus collaborations to support student advocacy skills	HGCC	225C	Campus Engagement	Intermediate
2:00 p.m.	2:30 p.m.	Successful Sustainability in Trumplandia: None of This New Reality is New to Me	HGCC	225D	Campus Engagement	Intermediate

Start Time	End Time	Event Title	Location	Room	Primary Track	Sess. Level
2:00 p.m.	2:30 p.m.	Developing a Green Office Program at your Institution	RC	Conf. Room 10	Campus Engagement	Introductory
2:00 p.m.	2:30 p.m.	Joining Forces to Restore Urban Woodland and Reconnect Students with Nature: A Model for Campus-Community-Commerce Collaboration	RC	Conf. Room 11	Public Engagement	Introductory
2:00 p.m.	2:30 p.m.	Community Engagement and Sustainable Buildings: A New Course from Pima Community College, Tucson 2030 District, and ENERGY STAR	RC	Conf. Room 12	Public Engagement	Intermediate
2:00 p.m.	2:30 p.m.	Transforming a Former Industrial Site into a Sustainable Solution and Creating Opportunities for Students	RC	Conf. Room 13	Research	Intermediate
2:00 p.m.	2:30 p.m.	Clarifying the Significance of Justice and Equity in Sustainability Education through Learning Outcomes and Course Designations	RC	Conf. Room 14	Curriculum	Intermediate
2:00 p.m.	2:30 p.m.	Designing Diverse Online Learning Environments as Laboratories for Connecting Across Difference	RC	Conf. Room 15	Curriculum	Introductory
2:00 p.m.	2:30 p.m.	Multiple Ways of Knowing in Sustainability Education: Stretching the Boundaries of Transformative Sustainability Learning	RC	Conf. Room 16	Curriculum	Advanced
2:00 p.m.	2:30 p.m.	Conservatives who conserve: How to talk about sustainability outside of politics	RC	Conf. Room 17	Campus Engagement	Intermediate
2:00 p.m.	2:30 p.m.	Gamification and Socialization of Sustainable Habits at Boston University Using the JouleBug Mobile App	RC	Conf. Room 18	Campus Engagement	Intermediate
2:00 p.m.	2:30 p.m.	Evaluating the Sustainability Outcomes Beyond LEED of Trinity University's Center for the Sciences and Innovation.	RW	Bonham	Buildings	Introductory
2:00 p.m.	2:30 p.m.	Benefits for Transitioning to in-House Dining - A Panel Discussion	RW	Bowie	Food & Dining	Intermediate
2:00 p.m.	2:30 p.m.	Engaging Partners in Source Reduction	RW	Salon A	Campus Engagement	Introductory
2:00 p.m.	2:30 p.m.	Beyond Waste Diversion: Advancing Sustainable Materials Management at Emory	RW	Salon B	Waste	Intermediate
2:00 p.m.	2:30 p.m.	The Climate Commitment: Getting the President to Move From 'no' to 'yes' -- and Then Maximizing the Impact of the Signature	RW	Salon C	Coordination & Planning	Intermediate
2:00 p.m.	2:30 p.m.	Data-Based Assessment of Wind Power Feasibility	RW	Salon D	Energy	Introductory
2:00 p.m.	2:30 p.m.	Cutting Carbon Through Electricity Diversification	RW	Salon E	Energy	Introductory
2:00 p.m.	2:30 p.m.	Arizona State University's Laboratory Standard and Design Guide	RW	Salon F	Buildings	Intermediate
2:00 p.m.	2:30 p.m.	Designing Menus for the Future: Sustainable Food Purchasing, Student Activism and Food Footprints	RW	Travis	Food & Dining	Intermediate
2:00 p.m.	2:30 p.m.	Transit Tech is Keeping Universities Safe and Sustainable	RW	Valero	Transportation	Introductory

Session H (2:00 p.m. - 3:00 p.m.) Panel Discussions and Films

2:45 p.m.	3:45 p.m.	Featured Session: Trends in climate change mitigation strategies. Which institutions are meeting their greenhouse gas reduction targets and why.	HGCC	221A	Air & Climate	Intermediate
2:45 p.m.	3:45 p.m.	Featured Session: Black Hills Food Hub: rural food hubs serving a wider demographic	RW	Travis	Public Engagement	Introductory
2:45 p.m.	3:45 p.m.	Techniques to Foster Interpersonal Competences	HGCC	221B	Coordination & Planning	Intermediate
2:45 p.m.	3:45 p.m.	Transforming Sustainability at Texas A&M University	HGCC	221C	Coordination & Planning	Intermediate
2:45 p.m.	3:45 p.m.	Strategic Alignment: Communicating Sustainability's Contributions and Value to Mission Level Priorities	HGCC	221D	Coordination & Planning	Advanced
2:45 p.m.	3:45 p.m.	Translating sustainability education and community action into solidarity by engaging underrepresented students in living labs	HGCC	223	Campus Engagement	Intermediate
2:45 p.m.	3:45 p.m.	Working in the Ivory Tower: Breaking Down the Walls of Academia	HGCC	225A	Campus Engagement	Advanced
2:45 p.m.	3:45 p.m.	Aligning Endowment Investments with the Paris Climate Agreement & the Sustainable Development Goals	HGCC	225B	Investment & Finance	Intermediate
2:45 p.m.	3:45 p.m.	Sustainability in Residential Life	HGCC	225C	Campus Engagement	Introductory
2:45 p.m.	3:45 p.m.	Gathering at the Table: Cultivating Future Leaders of a Thriving Community Food System	HGCC	225D	Campus Engagement	Intermediate
2:45 p.m.	3:45 p.m.	Promoting Sustainability Through Partnerships - A Collection of Case Studies	RC	Conf. Room 10	Campus Engagement	Intermediate
2:45 p.m.	3:45 p.m.	Innovation Districts: Collaborations of a City, a College and Corporations	RC	Conf. Room 11	Buildings	Advanced
2:45 p.m.	3:45 p.m.	Protest Meets Policy Change: Practical, Local Politics As Key to Building Community Solidarity and Sustainability	RC	Conf. Room 12	Public Engagement	Introductory
2:45 p.m.	3:45 p.m.	Sustainability Through the Eyes of Nature	RC	Conf. Room 13	Research	Intermediate
2:45 p.m.	3:45 p.m.	Sustainability and the Capstone Experience: Lessons from 5 Years of Applied Sustainability at Southwestern University	RC	Conf. Room 14	Curriculum	Intermediate
2:45 p.m.	3:45 p.m.	Connecting Community Partnerships with Curriculum to Strengthen Sustainability Education	RC	Conf. Room 15	Curriculum	Introductory
2:45 p.m.	3:45 p.m.	Engaging Students in Sustainability through High-Impact Teaching Practices: Two Case Studies	RC	Conf. Room 16	Curriculum	Introductory
2:45 p.m.	3:45 p.m.	Creating a Space for Collaboration and Cohort Building through Community Based Student Work Experiences	RC	Conf. Room 17	Campus Engagement	Intermediate
2:45 p.m.	3:45 p.m.	A Relay-Race, not a Sprint: Advancing Campus as Lab in Solidarity	RC	Conf. Room 18	Campus Engagement	Intermediate
2:45 p.m.	3:15 p.m.	Leveraging Living Building Challenge Standards across Campus Operations	RW	Bonham	Buildings	Intermediate
2:45 p.m.	3:45 p.m.	Fishing for Solutions: How Sourcing Sustainable and Affordable Seafood Fits into Your Campus Foodservice and Sustainability Programs	RW	Bowie	Food & Dining	Introductory
2:45 p.m.	3:45 p.m.	Surplus Assets Deserve to be Reused, Not Discarded	RW	Salon A	Waste	Introductory

Start Time	End Time	Event Title	Location	Room	Primary Track	Sess. Level
2:45 p.m.	3:45 p.m.	Expanding the Horizons of Campus Recycling: Addressing Expanded Polystyrene Waste at Three Institutions of Higher Education	RW	Salon B	Waste	Introductory
2:45 p.m.	3:45 p.m.	Carbon Pricing in Higher Education: Panel with 3 Models for Internal Carbon Pricing and Engaging in National Leadership	RW	Salon C	Air & Climate	Intermediate
2:45 p.m.	3:45 p.m.	Being a RE-Volv Solar Ambassador on your Campus and in your Community: Practical and Curricular Training and Experiences	RW	Salon D	Energy	Introductory
2:45 p.m.	3:45 p.m.	Diverse Paths to Success: Three High-Impact Infrastructure Projects that Reduced Energy Consumption and Emissions	RW	Salon E	Energy	Intermediate
2:45 p.m.	3:45 p.m.	Passive House Applications for Campus Buildings	RW	Salon F	Energy	Introductory
2:45 p.m.	3:45 p.m.	Sustainable Transportation Programs: Nationwide Trends & Practical Case Studies	RW	Valero	Transportation	Introductory
Tuesday Afternoon Events						
4:00 p.m.	5:15 p.m.	Closing Keynote - Michael J. Sorrell	HGCC	Stars at Night Ballroom		
Wednesday, 10/18/17						
(\$) Post-Conference Workshops and Tour						
7:00 a.m.	9:00 a.m.	Registration Open	HGCC	Main Lobby		
8:00 a.m.	12:00 p.m.	Trinity University's Center for the Sciences & Innovation: A Campus Hub for Collaborative Learning (\$)	HGCC	Main Lobby	Coordination & Planning	Advanced
9:00 a.m.	11:30 a.m.	Sustainability in the Works at UTSA (\$)	HGCC	Main Lobby	Wellbeing & Work	Intermediate
8:30 a.m.	4:00 p.m.	Senior Leadership Summit: Positioning Sustainability as Your Ultimate Innovation and Strategy Driver (\$)	HGCC	223	Coordination & Planning	Advanced
8:30 a.m.	4:00 p.m.	Carbon Pricing & Higher Ed: Internal Carbon Fees, Using Shadow Prices for Life Cycle Analysis, & Engaging Beyond the Campus (\$)	HGCC	221D	Air & Climate	Intermediate
8:30 a.m.	12:00 p.m.	Catch: A Face-to-Face Dynamic Simulation Game for Teaching About Renewable Natural Resource Management and Sustainability (\$)	HGCC	221C	Curriculum	Intermediate
8:30 a.m.	12:00 p.m.	In Serving Solidarity, Let's Talk about Privilege: Critical Conversations About 'Unsustainable' Race, Class & Gender Privilege (\$)	HGCC	225A	Diversity & Affordability	Advanced
8:30 a.m.	12:00 p.m.	Climate Action (re)Boot Camp! (\$)	HGCC	225B	Air & Climate	Introductory
8:30 a.m.	12:00 p.m.	Sustaining Ourselves - A Collaborative Mini-Retreat for Sustainability Professionals (\$)	HGCC	225D	Wellbeing & Work	Intermediate



MAIN LOBBY

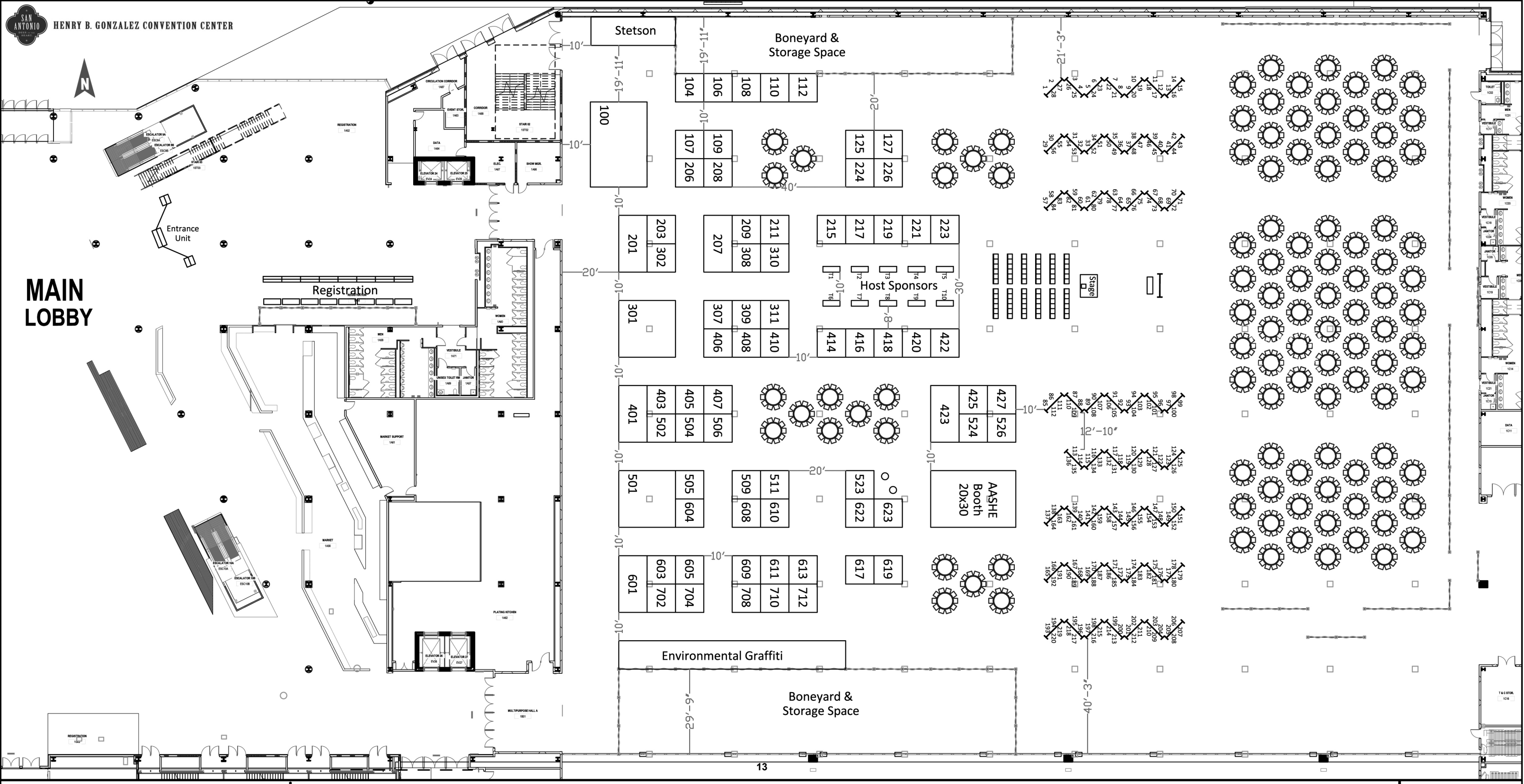

TO
ALAMODOME



HENRY B. GONZALEZ CONVENTION CENTER **Street Level**



ALAMO STREET

MARKET STREET

Meeting Level

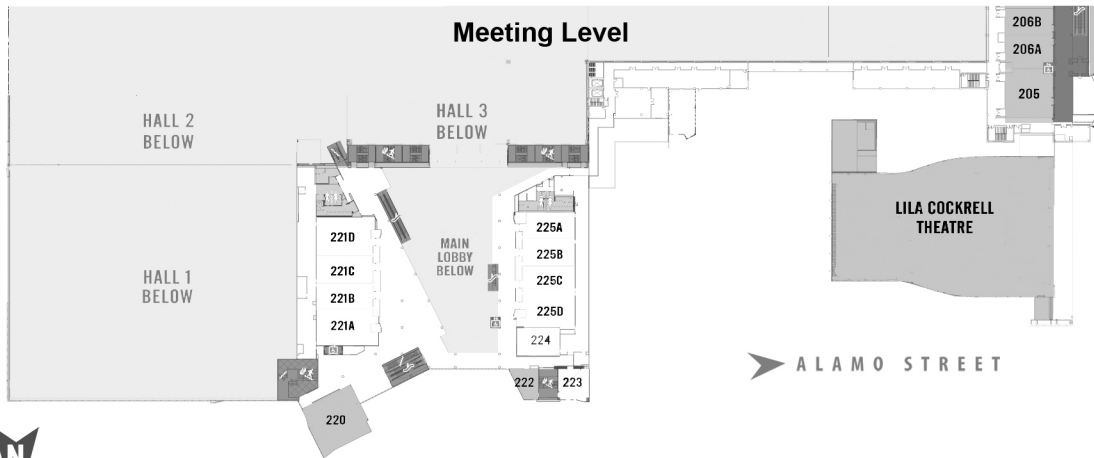

TOWER OF THE AMERICAS WAY



ALAMO STREET

MARKET STREET

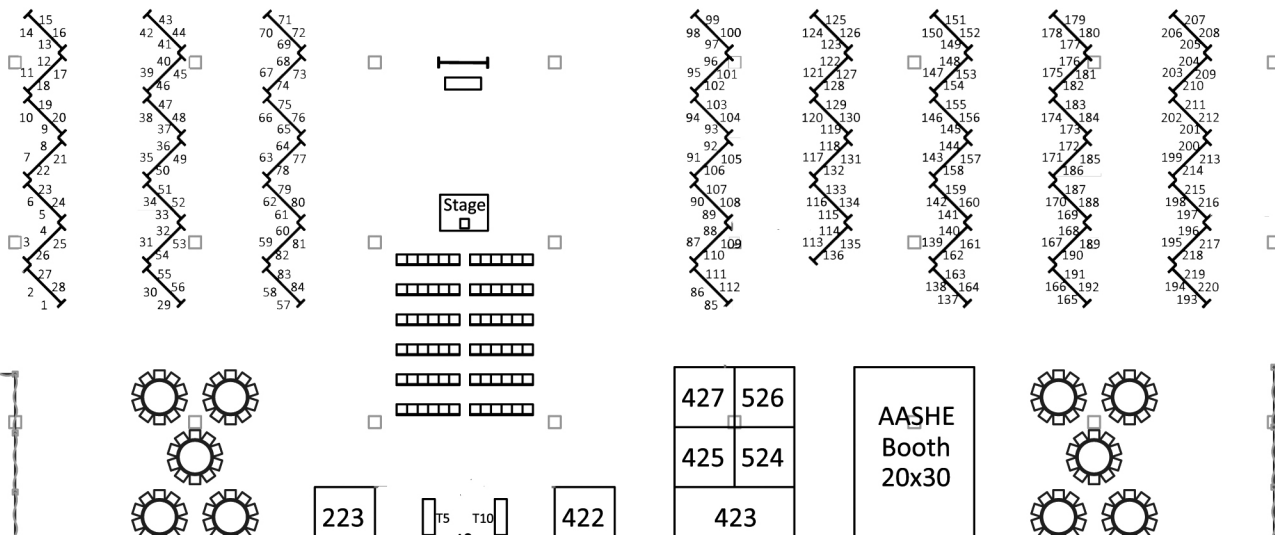

- Academics Posters 1-33
- Engagement Posters 34-104
- Operations Posters 105-186
- Planning & Administration Posters 187-end

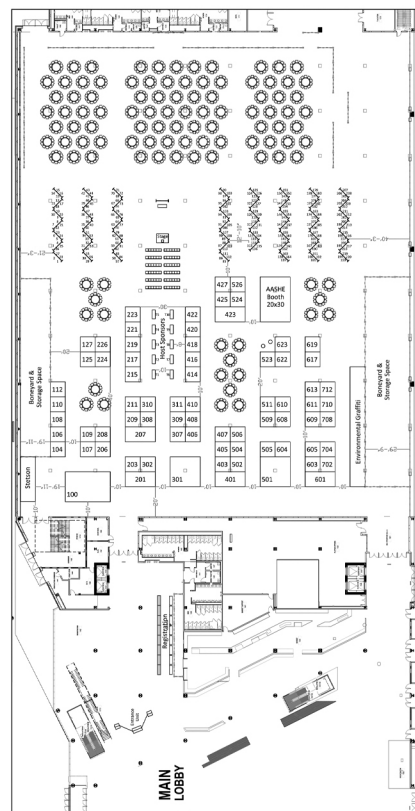

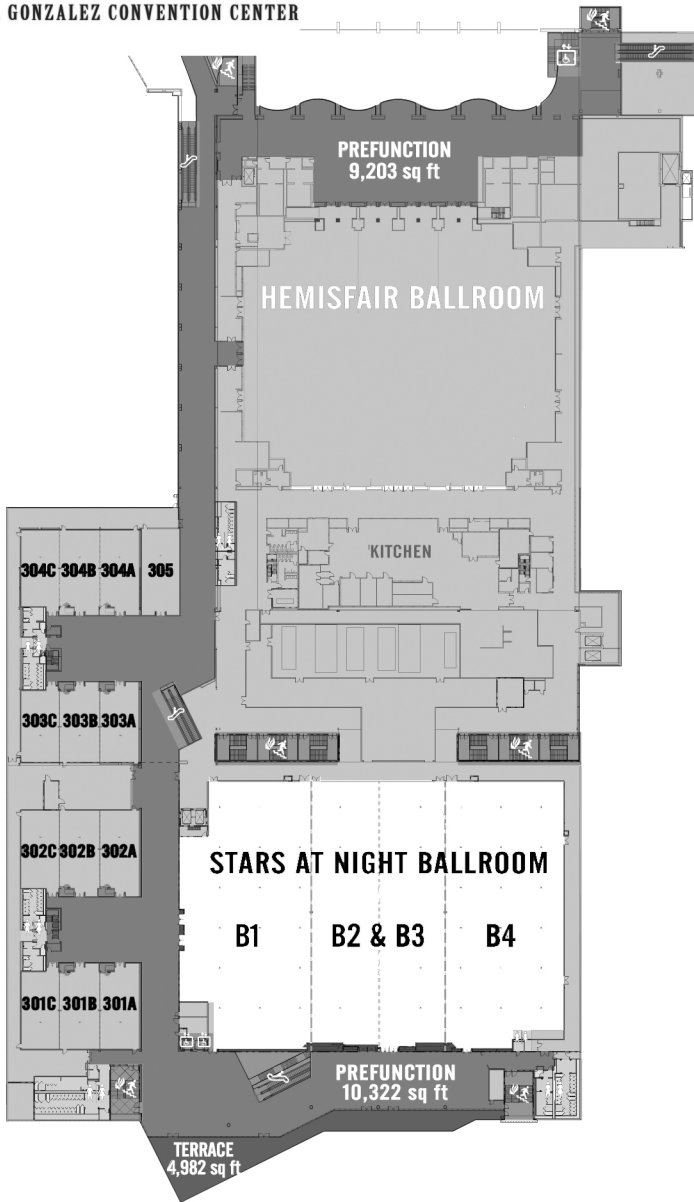



**MARRIOTT
SAN ANTONIO
RIVERWALK**

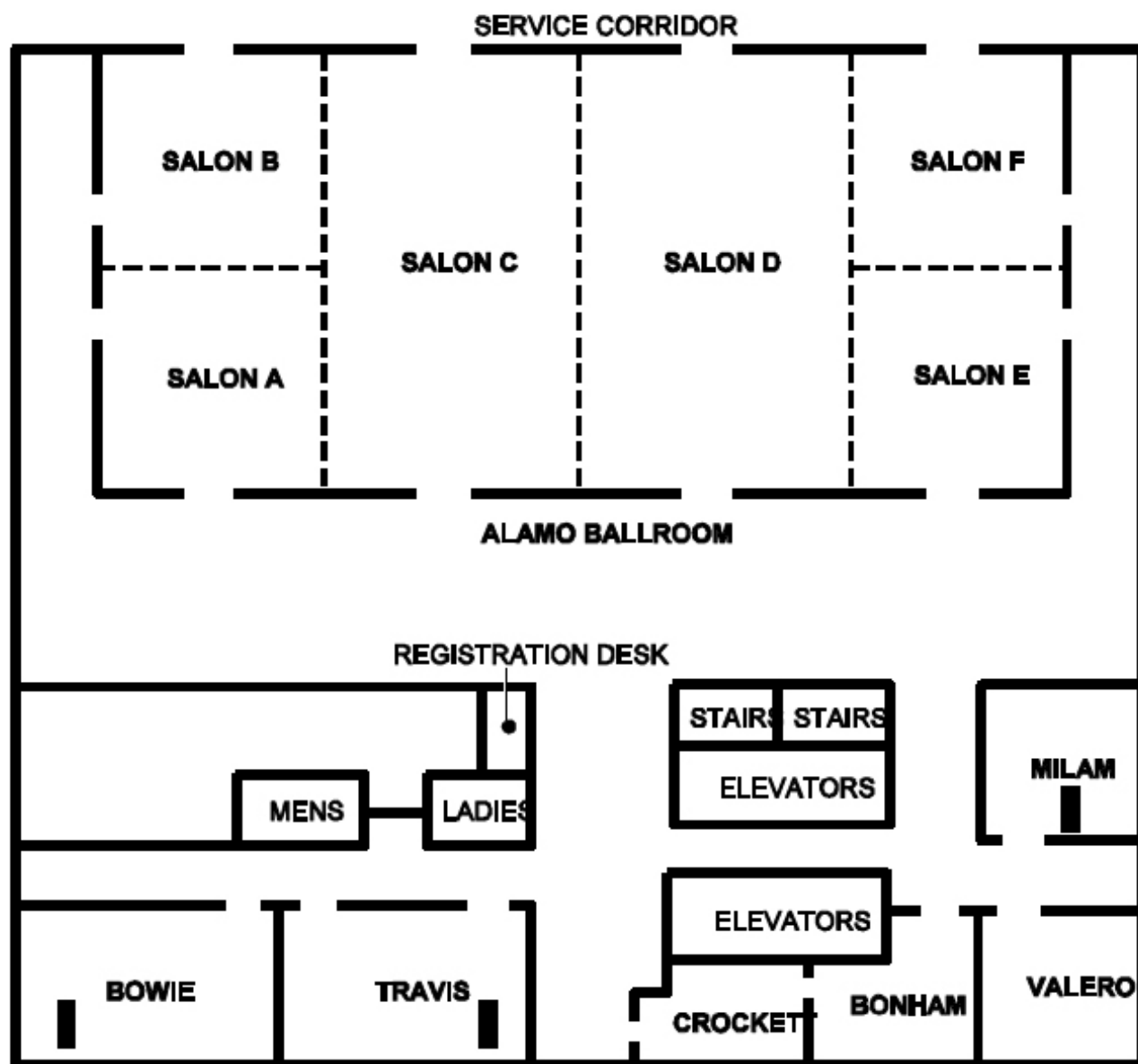

BALLROOM LEVEL (SECOND FLOOR)



MARRIOTT SAN ANTONIO RIVERCENTER

